

STATE OF WISCONSIN
DEPARTMENT OF NATURAL RESOURCES

LAKE SURVEY MAP

HARPT LAKE MANITOWOC COUNTY
SEC. 17 T. 21 N. R. 23 E.

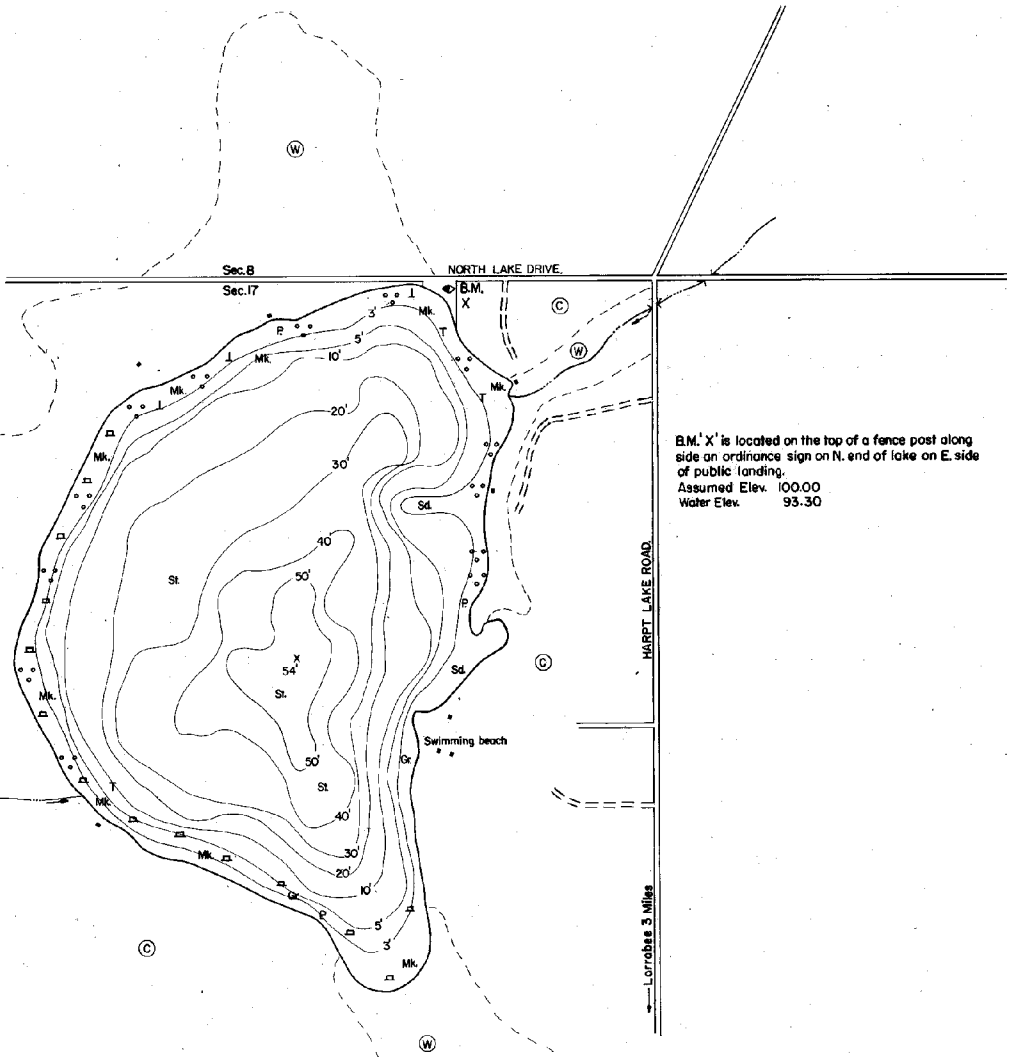
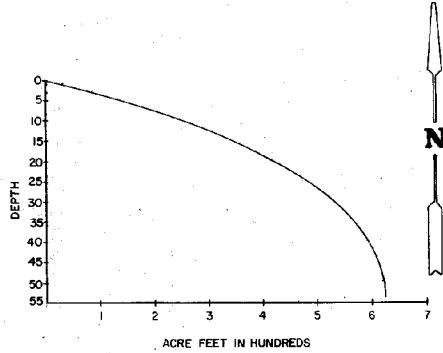

B.M. X' is located on the top of a fence post along side an ordinance sign on N. end of lake on E. side of public landing.
Assumed Elev. 100.00
Water Elev. 93.30

EQUIPMENT	RECORDING	SONAR	MAPPED	1973
			MONTH	YEAR
TOPOGRAPHIC SYMBOLS				
(B) Brush		Steep slope	P. Peat	B Boulders
(PW) Partially wooded	-----	Indefinite shoreline	Mk. Muck	☼ Stumps & Snags
(W) Wooded	-----	Marsh	C. Clay	☼ Rock danger to navigation
(C) Cleared	-----	Spring	M. Marl	T Submergent vegetation
(P) Pastured	-----	Intermittent stream	Sd. Sand	⊥ Emergent vegetation
(A) Agricultural	-----	Permanent inlet	Sl. Silt	⊥ Floating vegetation
B.M. Bench Mark	-----	Permanent outlet	Gr. Gravel	⊥ Brush shelters
■ Dwelling	-----	Dam	R. Rubble	
▣ Resort	-----	D.N.R. State owned land	Be Bedrock	
▣ Camp	-----			

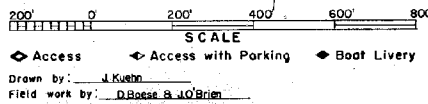

SPECIES OF FISH	1973	
	Abundant	Present
Muskie		
N. Pike	X	
Walleye	X	
L. M. Bass	X	
S. M. Bass	X	
Panfish	X	
Trout		

WATER AREA 31.4 ACRES
UNDER 3 FT. 13 %
OVER 20 FT. 45 %
MAX. DEPTH 54 FEET.
TOTAL ALK. 120 P.P.M.
VOLUME 623.9 ACRE FT.
SHORELINE .95 MILES

Maps are not for navigation
Source-Wisconsin Department of Natural Resources
Hunt Fish Camp Wisconsin .Com 2005