

STATE OF WISCONSIN
DEPARTMENT OF NATURAL RESOURCES

LAKE SURVEY MAP

HALF MOON LAKE BAYFIELD COUNTY
SEC. 8 17 T. 47 N. R. 8 W.

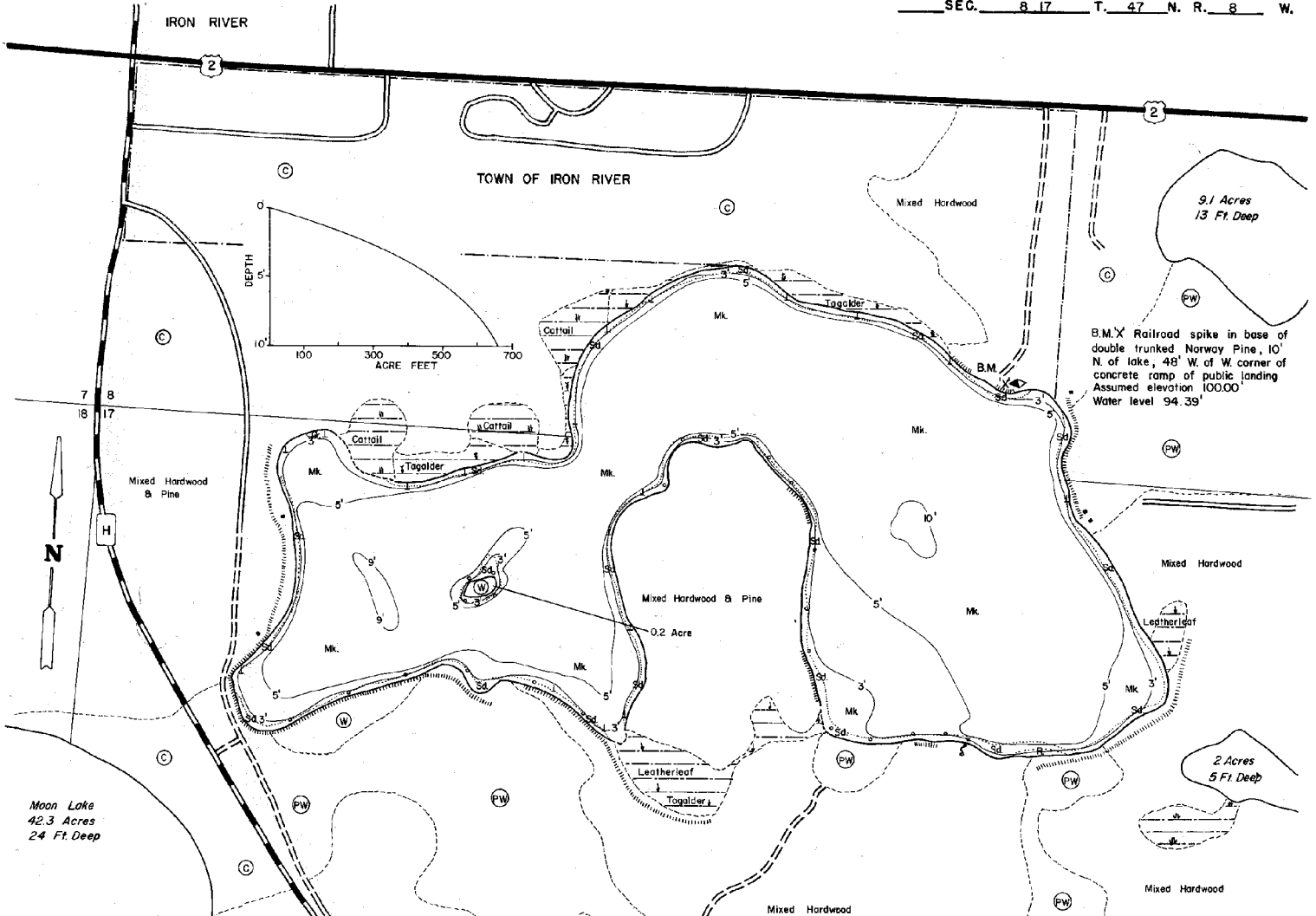

Moon Lake
42.3 Acres
24 Ft. Deep

9.1 Acres
13 Ft. Deep

B.M. X Railroad spike in base of double trunked Norway Pine, 10' N. of lake, 48' W. of W. corner of concrete ramp of public landing
Assumed elevation 100.00'
Water level 94.39'

EQUIPMENT RECORDING SONAR MAPPED APRIL 1969
MONTH YEAR
LAKE BOTTOM SYMBOLS

- | | | |
|--|--|---|
| <p>TOPOGRAPHIC SYMBOLS</p> <ul style="list-style-type: none"> ⊙ Brush ⊙ Partially wooded ⊙ Wooded ⊙ Cleared ⊙ Pastured ⊙ Agricultural B.M. Bench Mark Dwelling Resort Camp | <ul style="list-style-type: none"> Steep slope Indefinite shoreline Marsh Spring Intermittent stream Permanent inlet Permanent outlet Dam D.N.R. State owned land | <p>LAKE BOTTOM SYMBOLS</p> <ul style="list-style-type: none"> P. Peat Mk. Muck C. Clay M. Marl Sd. Sand Sl. Silt Gr. Gravel R. Rubble Bc. Bedrock B. Boulders Stumps & Snags Rock danger to navigation Submergent vegetation Emergent vegetation Floating vegetation Brush shelters |
|--|--|---|

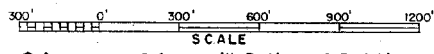

Access Access with Parking Boat Livery
Drawn by: C. Holt
Field work by: C. Busch, C. Belter, S. Johannes

SPECIES OF FISH	LAKE BOTTOM SYMBOLS		
	Abundant	Common	Scarcity
Muskie			
N. Pike	X		
Walleye			
L. N. Bass	X		
S. N. Bass			
Perch	X		
Trout			

WATER AREA 106.3 ACRES
UNDER 3 FT. 8.7 %
OVER 20 FT. 0 %
MAX. DEPTH 10 FEET.
TOTAL ALK. 49 P.P.M.
VOLUME 658.3 ACRE FT.
SHORELINE 2.54 MILES
SHORELINE 2.75 MILES WITH IS.

Maps are not for navigation
Source-Wisconsin Department of Natural Resources
Hunt Fish Camp Wisconsin .Com 2005