

STATE OF WISCONSIN
DEPARTMENT OF NATURAL RESOURCES

LAKE SURVEY MAP

GANDER LAKE DOUGLAS COUNTY
SEC. 22 T. 46 N. R. 11 W.

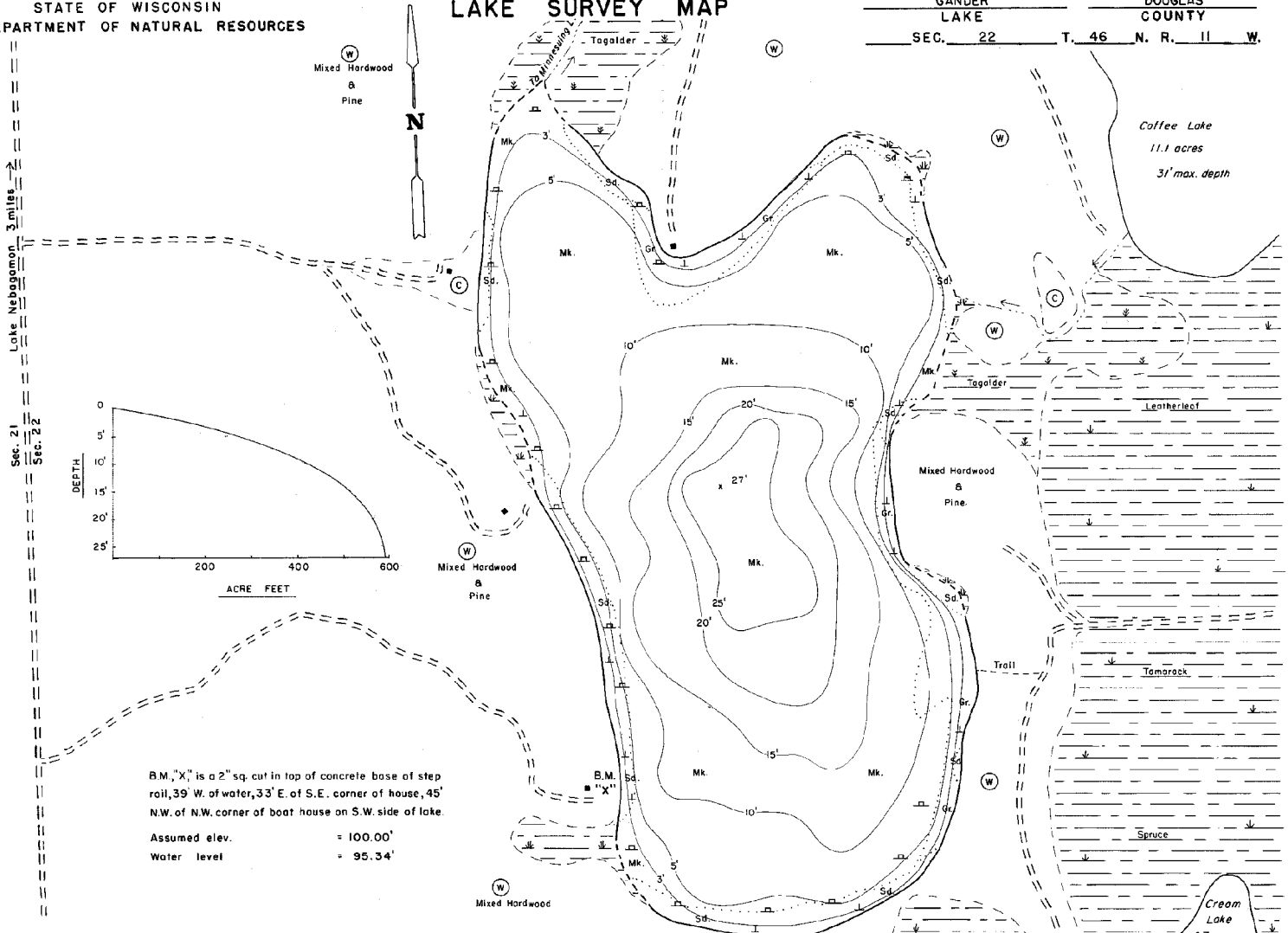

B.M. "X" is a 2" sq. cut in top of concrete base of step rail, 39' W. of water, 33' E. of S.E. corner of house, 45' N.W. of N.W. corner of boat house on S.W. side of lake.

Assumed elev. = 100.00'
Water level = 95.34'

EQUIPMENT RECORDING SONAR MAPPED JULY 1971

TOPOGRAPHIC SYMBOLS	MONTH	YEAR
	LAKE BOTTOM	SYMBOLS
(B) Brush	P. Peat	B Boulders
(PW) Partly wooded	Mk. Muck	St Stumps & Snags
(W) Wooded	C. Clay	RD Rock danger to navigation
(C) Cleared	M. Marl	T Submergent vegetation
(P) Pastured	Sd. Sand	I Emergent vegetation
(A) Agricultural	Sl. Silt	FV Flooding vegetation
B.M. Bench Mark	Gr. Gravel	BS Brush shelters
(D) Dwelling	R. Rubble	
(R) Resort	Bt. Bedrock	
(C) Camp		
	D.N.R. State owned land	

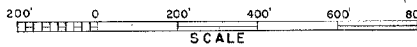

Access Access with Parking Boat Livery

Drawn by: T. Glander
Field work by: C. Busch, G. Lund, L. Sather

SPECIES OF FISH	1971		
	Abundant	Common	Present
Muskie			
N. Pike			X
Walleye			X
L. M. Bass			X
S. M. Bass			X
Panfish			X
Trou			

WATER AREA 54.4 ACRES
UNDER 3 FT. 11 %
OVER 20 FT. 13 %
MAX. DEPTH 27 FEET
TOTAL ALK. 29 P.P.M.
VOLUME 594 ACRE FT.
SHORELINE 1.39 MILES

Maps are not for navigation
Source-Wisconsin Department of Natural Resources
Hunt Fish Camp Wisconsin .Com 2005