

WISCONSIN CONSERVATION DEPARTMENT

LAKE SURVEY MAP

FRIENDSHIP

ADAMS

LAKE

COUNTY

SEC. 5, 4, 32, 33

T. 17, 18 - N. R. - 6 - E.

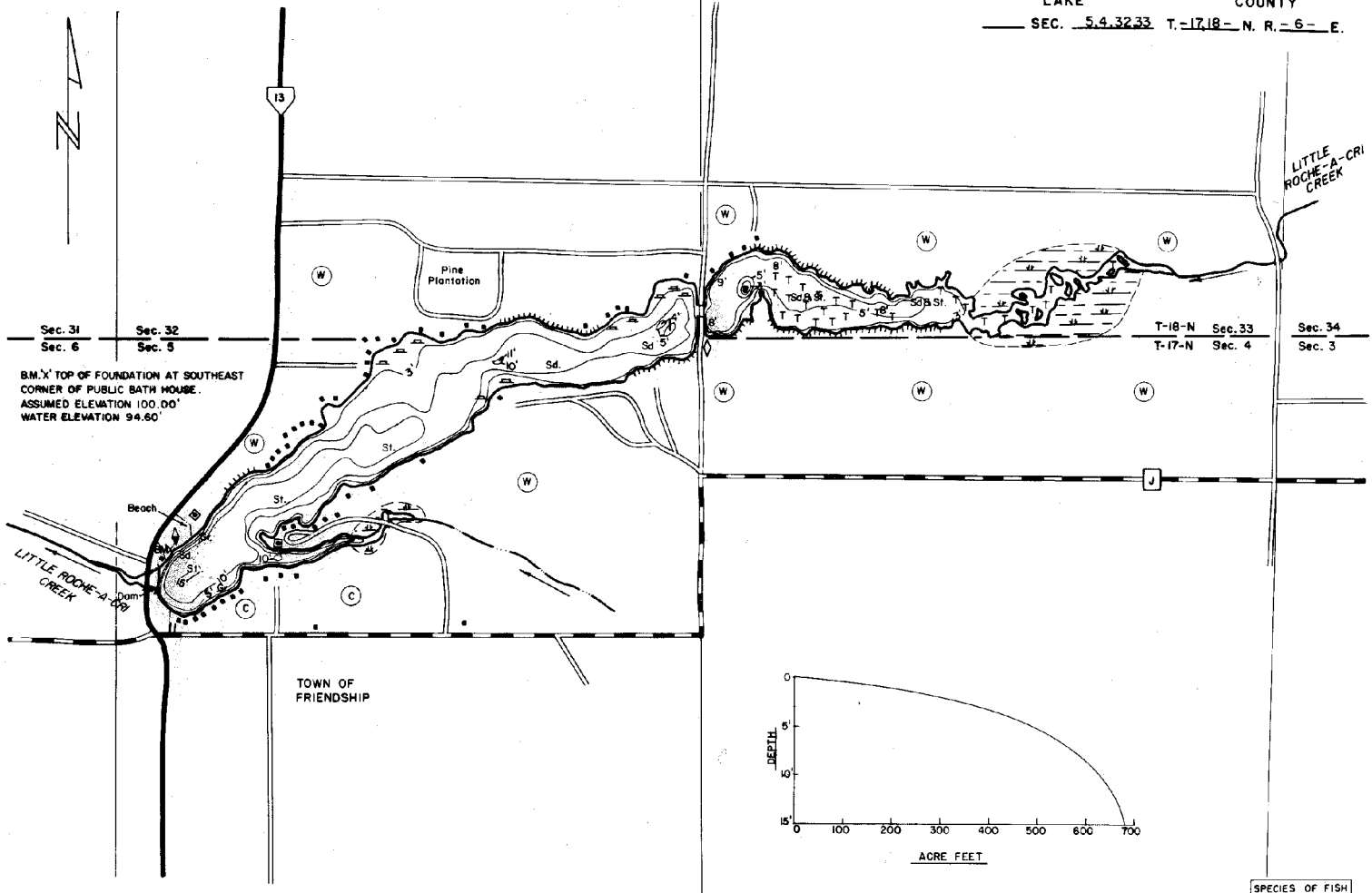

B.M. X TOP OF FOUNDATION AT SOUTHEAST CORNER OF PUBLIC BATH HOUSE. ASSUMED ELEVATION 100.00' WATER ELEVATION 94.60'

EQUIPMENT ECHO SOUNDER MAPPED SEPT. 1965  
MO. YR.

- TOPOGRAPHIC SYMBOLS
- Brush
  - Partially wooded
  - Wooded
  - Cleared
  - Agricultural
  - B.M. Bench Mark
  - Dwelling
  - Resort
- WATER ELEV. 94.60'
- LAKE BOTTOM SYMBOLS
- P. Peat
  - Mk. Muck
  - C. Clay
  - M. Marl
  - Sd. Sand
  - St. Silt
  - Gr. Gravel
  - R. Rubble
  - Br. Bedrock
  - T. Submergent vegetation
  - J. Emergent vegetation
  - F. Floating vegetation
  - Stumps & Snags

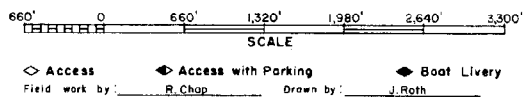

SPECIES OF FISH		Abundant	Common	Rare
Muskie				
N. Pike				X
Walleye				X
L.M. Bass	X			
S.M. Bass				
Panfish	X			
Tilapia				

115.0 With islands  
AREA 114.2 ACRES  
UNDER 3 FT. 8.9 %  
OVER 20 FT. 0 %  
VOLUME 680.6 ACRE FT.  
TOTAL ALK. 95 P.P.M.  
SHORELINE 5.9 MILES  
MAX. DEPTH 15 FEET

Maps are not for navigation  
Source-Wisconsin Department of Natural Resources  
Hunt Fish Camp Wisconsin .Com 2005