

STATE OF WISCONSIN
DEPARTMENT OF NATURAL RESOURCES

LAKE SURVEY MAP

FAIRCHILD POND LAKE
EAU CLAIRE COUNTY
SEC. 35 T. 25 N. R. 5 W.

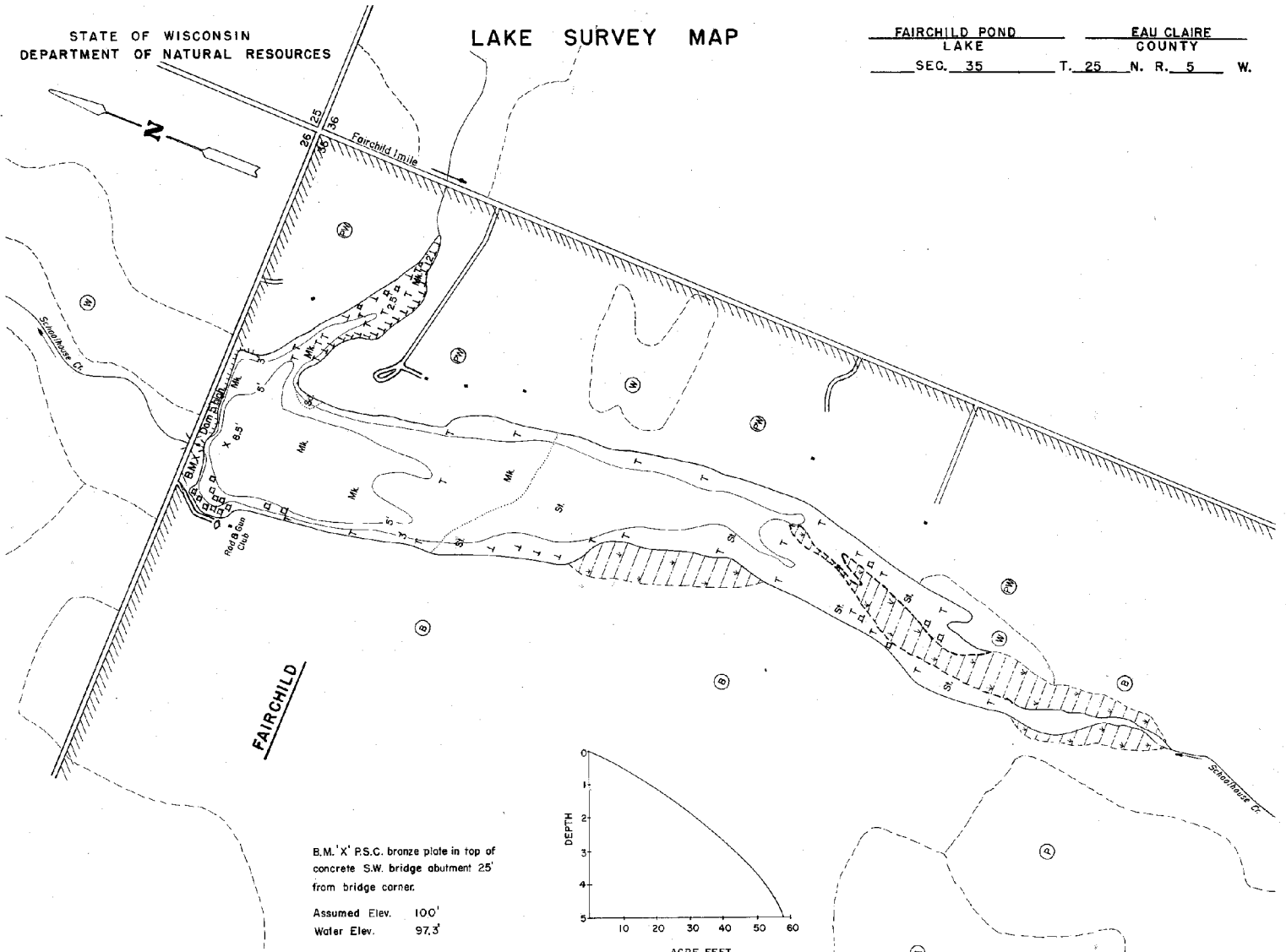

FAIRCHILD

B.M. 'X' P.S.C. bronze plate in top of concrete S.W. bridge abutment 25' from bridge corner.
Assumed Elev. 100'
Water Elev. 97.3'

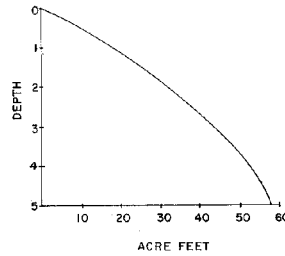

| EQUIPMENT | RANGE POLE | MAPPED | JUNE | 1972 |
|----------------------|------------|-------------------------|-------------|-----------------------------|
| TOPOGRAPHIC SYMBOLS | | MONTH | YEAR | LAKE BOTTOM SYMBOLS |
| (B) Brush | | Steep slope | P. Peat | B. Boulders |
| (W) Partially wooded | ----- | Indefinite shoreline | Mk. Muck | ⊙ Stumps & Snags |
| (W) Wooded | ----- | Marsh | C. Clay | ⊗ Rock danger to navigation |
| (C) Cleared | ----- | Spring | M. Marl | T Submergent vegetation |
| (P) Pastured | ----- | Intermittent stream | Sd. Sand | ⊥ Emergent vegetation |
| (A) Agricultural | ----- | Permanent inlet | Sl. Silt | ⊥ Floating vegetation |
| E.M. Bench Mark | ----- | Permanent outlet | Gr. Gravel | ⊕ Brush shelters |
| ■ Dwelling | ----- | Dam | R. Rubble | |
| □ Resort | ----- | D.N.R. State owned land | Bc. Bedrock | |
| ⊠ Camp | ----- | | | |

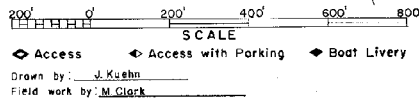

| SPECIES OF FISH | ABUNDANCE | |
|-----------------|-----------|---------|
| | ABUNDANT | PRESENT |
| Muskie | | |
| N. Pike | | |
| Walleye | | |
| L.M. Bass | X | |
| S.M. Bass | | |
| Panfish | X | |
| Trout | | |

WATER AREA 17.96 ACRES
UNDER 3 FT. 39 %
OVER 20 FT. 0 %
MAX. DEPTH 8.5 FEET.
TOTAL ALK. 22 P.P.M.
VOLUME 58.05 ACRE FT.
SHORELINE 1.67 MILES

Maps are not for navigation
Source-Wisconsin Department of Natural Resources
Hunt Fish Camp Wisconsin .Com 2005