

STATE OF WISCONSIN
DEPARTMENT OF NATURAL RESOURCES

LAKE SURVEY MAP

ELLSWORTH LAKE
SEC. 17, 18 T. 39 N. R. 13 W.
WASHBURN COUNTY

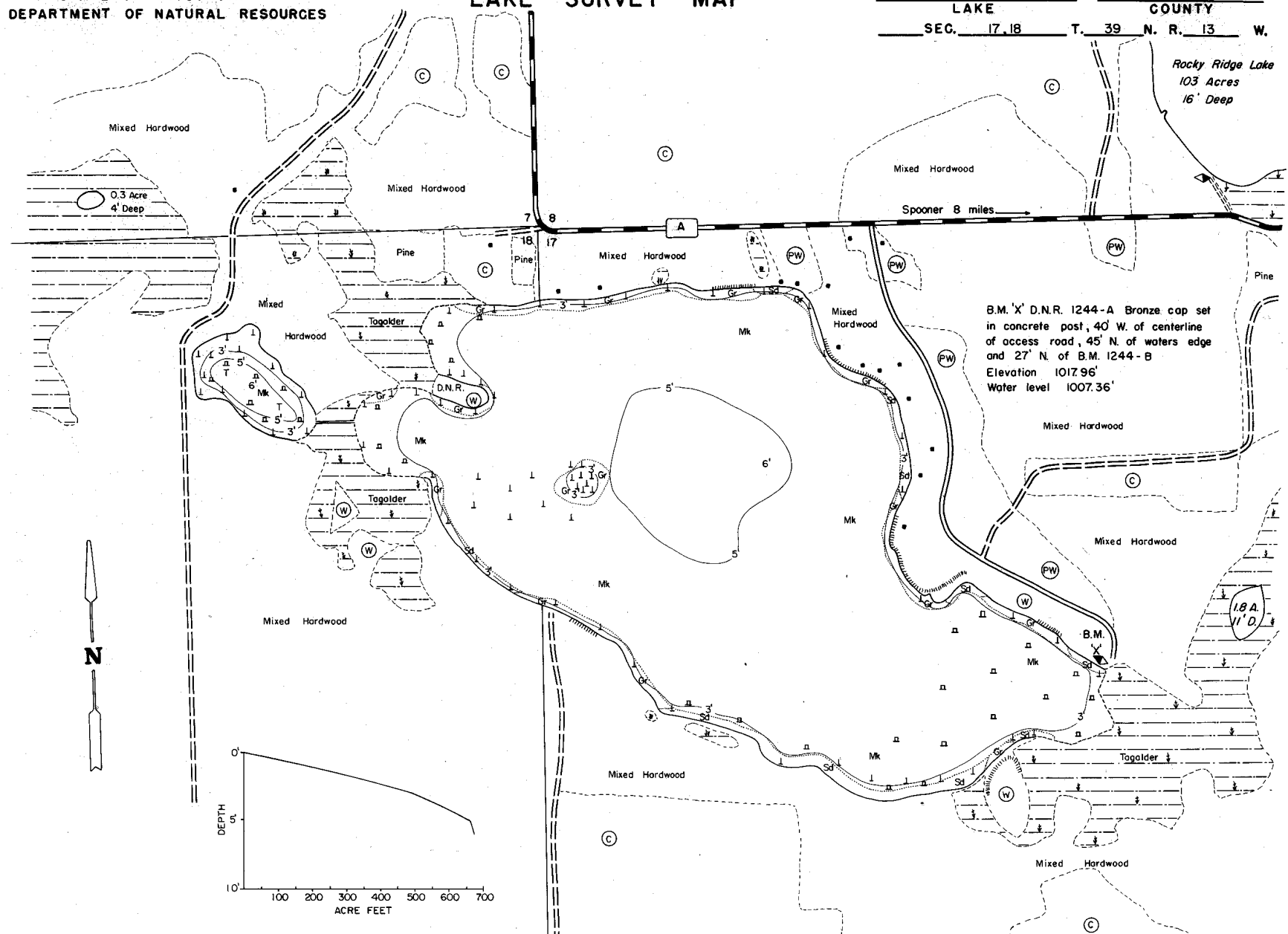

Rocky Ridge Lake
103 Acres
16' Deep

B.M. 'X' D.N.R. 1244-A Bronze cap set
in concrete post, 40' W. of centerline
of access road, 45' N. of waters edge
and 27' N. of B.M. 1244-B
Elevation 1017.96'
Water level 1007.36'

EQUIPMENT	RECORDING	SONAR	MAPPED	JUNE	1971	
TOPOGRAPHIC SYMBOLS			MONTH	YEAR	LAKE BOTTOM SYMBOLS	
(B) Brush		Steep slope	P.	Peat	B	Boulders
(PW) Partially wooded	- - - - -	Indefinite shoreline	Mk.	Muck	⊙	Stumps & Snags
(W) Wooded		Marsh	C.	Clay	⊙	Rock danger to navigation
(C) Cleared		Spring	M.	Marl	T	Submergent vegetation
(P) Pastured		Intermittent stream	Sd.	Sand	J	Emergent vegetation
(A) Agricultural		Permanent inlet	St.	Silt	⊙	Floating vegetation
B.M. Bench Mark		Permanent outlet	Gr.	Gravel	⊙	Brush shelters
Dwelling		Dam	R.	Rubble		

SCALE
400' 0' 400' 800' 1200' 1600'

◆ Access ◆ Access with Parking ◆ Boat Livery
Drawn by: C. Holt

SPECIES OF FISH	ABUNDANCE	
	Common	Present
Muskie		
N. Pike	X	
Walleye		
L.M. Bass	X	
S.M. Bass		
Panfish	X	
Trout		

WATER AREA 173.8 ACRES
UNDER 3 FT. 12 %
OVER 20 FT. 0 %
MAX. DEPTH 6 FEET.
TOTAL ALK. 37 P.P.M.
VOLUME 673 ACRE FT.
SHORELINE 3.05 MILES