

STATE OF WISCONSIN
DEPARTMENT OF NATURAL RESOURCES

LAKE SURVEY MAP

EAST WILCOX LAKE
WASHBURN COUNTY
SEC. 13, 18 T. 41 N. R. 12, 13 W.

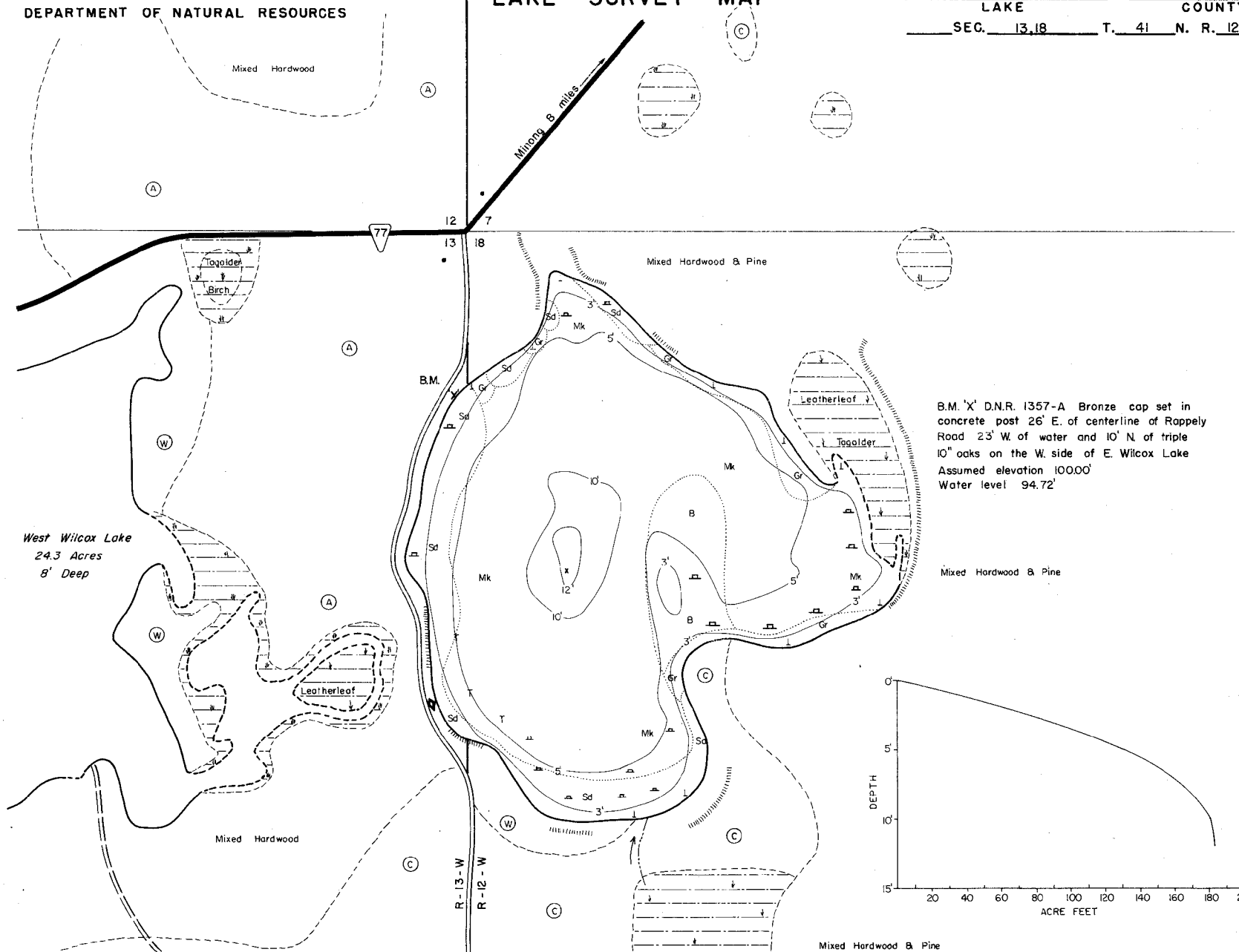

B.M. 'X' D.N.R. 1357-A Bronze cap set in concrete post 26' E. of centerline of Rappely Road 23' W. of water and 10' N. of triple 10" oaks on the W. side of E. Wilcox Lake
Assumed elevation 100.00'
Water level 94.72'

West Wilcox Lake
24.3 Acres
8' Deep

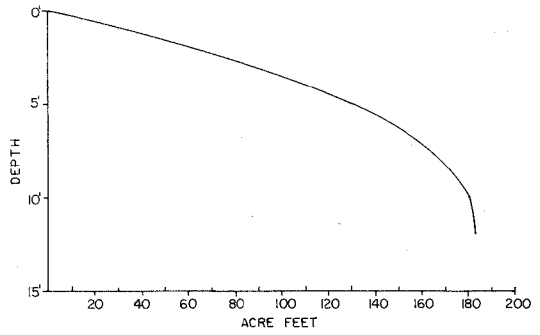

EQUIPMENT RECORDING SONAR MAPPED MAY 1972

- | TOPOGRAPHIC SYMBOLS | | LAKE BOTTOM SYMBOLS | |
|-----------------------|----------------------------|---------------------|-----------------------------|
| (B) Brush | Steep slope | P. Peat | B Boulders |
| (PW) Partially wooded | ----- Indefinite shoreline | Mk. Muck | ⊙ Stumps & Snags |
| (W) Wooded | Marsh | C. Clay | ⊙ Rock danger to navigation |
| (C) Cleared | Spring | M. Marl | T Submergent vegetation |
| (P) Pastured | ----- Intermittent stream | Sd. Sand | L Emergent vegetation |
| (A) Agricultural | ==== Permanent inlet | Sl. Silt | F Floating vegetation |
| B.M. Bench Mark | ==== Permanent outlet | Gr. Gravel | ⊙ Brush shelters |



SPECIES OF FISH			
Species	Abundant	Common	Present
Occasional Winter Kill			
Muskie			
N. Pike			
Walleye			
L. M. Bass	X		
S. M. Bass			

WATER AREA 30.6 ACRES
UNDER 3 FT. 13 %
OVER 20 FT. 0 %
MAX. DEPTH 12 FEET.
TOTAL ALK. 6 P.P.M.
VOLUME 184 ACRE FT.