

STATE OF WISCONSIN
DEPARTMENT OF NATURAL RESOURCES

LAKE SURVEY MAP

EAST LAKE POLK COUNTY
SEC. 15, 16, 21, 22 T. 33 N. R. 18 W.

B.M. 'X' Rail road spike in the base of the W. side of a 24" oak, 9' W of centerline of access road and 120' N. of lake
Assumed elevation 100.00'
Water level 93.10'

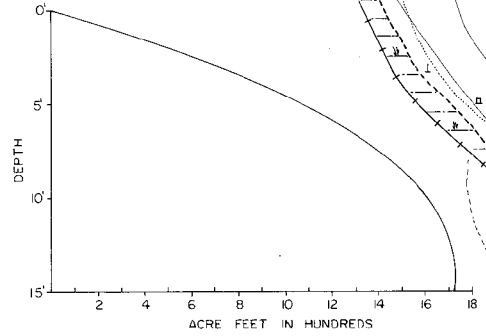
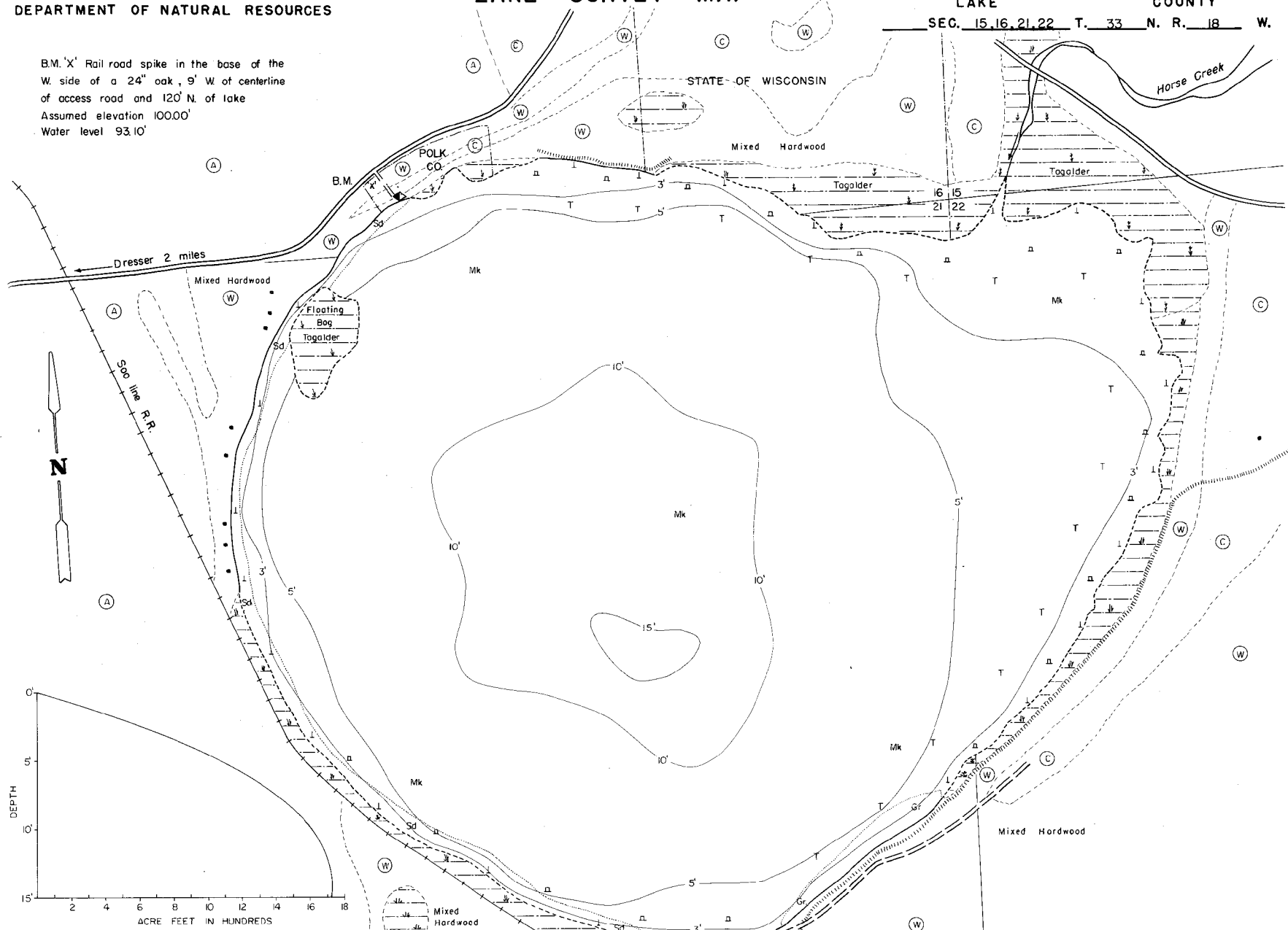

EQUIPMENT RECORDING SONAR MAPPED MAY 1971
LAKE BOTTOM SYMBOLS

- | | | |
|-----------------------|----------------------------|-----------------------------|
| (B) Brush | () Steep slope | P. Peat |
| (PW) Partially wooded | (---) Indefinite shoreline | Mk. Muck |
| (W) Wooded | (---) Marsh | C. Clay |
| (C) Cleared | (---) Spring | M. Marl |
| (P) Pastured | (---) Intermittent stream | Sd. Sand |
| (A) Agricultural | (---) Permanent inlet | Sl. Silt |
| B.M. Bench Mark | (---) Permanent outlet | Gr. Gravel |
| | | B Boulders |
| | | o Stumps & Snags |
| | | ⊗ Rock danger to navigation |
| | | T Submergent vegetation |
| | | ⊥ Emergent vegetation |
| | | ⊥ Floating vegetation |
| | | ⊥ Brush shelters |

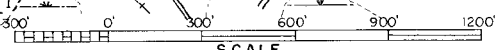

Access Access with Parking Boat Livery

SPECIES OF FISH	1971		
	Abundant	Common	Present
Winterkill			
Muskie		X	
N. Pike		X	
Walleye		X	
L.M. Bass		X	
S.M. Bass		X	
Panfish	X		

WATER AREA 245.9 ACRES
UNDER 3 FT. 12.2 %
OVER 20 FT. 0 %
MAX. DEPTH 15 FEET.
TOTAL ALK. 76 P.P.M.
VOLUME 1724 ACRE FT.
SHORELINE 3.20 MILES