

STATE OF WISCONSIN
DEPARTMENT OF NATURAL RESOURCES

LAKE SURVEY MAP

EAGLE LAKE
VILAS COUNTY
SEC. 22, 23, 26 T. 40 - N. R. 10 - E.

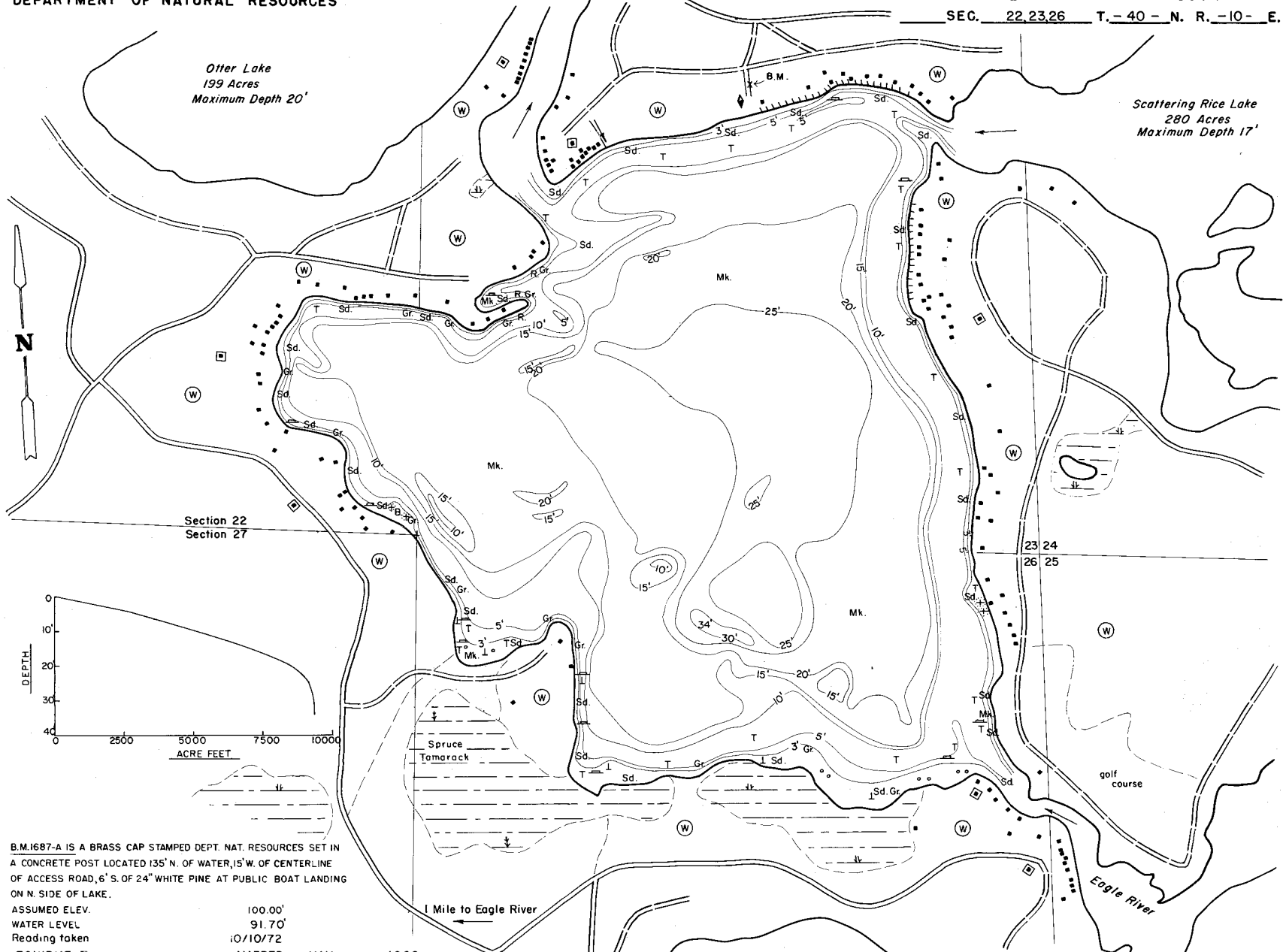

Otter Lake
199 Acres
Maximum Depth 20'

Scattering Rice Lake
280 Acres
Maximum Depth 17'

Dollar Lake
105 Acres
Maximum Depth 15'

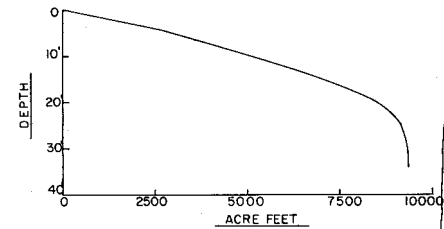

B.M.1687-A IS A BRASS CAP STAMPED DEPT. NAT. RESOURCES SET IN A CONCRETE POST LOCATED 135' N. OF WATER, 15' W. OF CENTERLINE OF ACCESS ROAD, 6' S. OF 24" WHITE PINE AT PUBLIC BOAT LANDING ON N. SIDE OF LAKE.
ASSUMED ELEV. 100.00'
WATER LEVEL 91.70'
Reading taken 10/10/72

- EQUIPMENT RECORDING SONAR MAPPED MAY 1969
- | TOPOGRAPHIC SYMBOLS | | LAKE BOTTOM SYMBOLS | |
|-----------------------|----------------------------|---------------------|-----------------------------|
| (B) Brush | Steep slope | P. Peat | B Boulders |
| (PW) Partially wooded | - - - Indefinite shoreline | Mk. Muck | ⚡ Stumps & Snags |
| (W) Wooded | ⊞ Marsh | C. Clay | ⚡ Rock danger to navigation |
| (C) Cleared | ⊞ Spring | M. Marl | T Submergent vegetation |
| (P) Pastured | ⊞ Intermittent stream | Sd. Sand | ⊞ Emergent vegetation |
| (A) Agricultural | ⊞ Permanent inlet | Sl. Silt | ⊞ Floating vegetation |
| B.M. Bench Mark | ⊞ Permanent outlet | Gr. Gravel | ⊞ Brush shelters |
| ■ Dwelling | ⊞ Dam | R. Rubble | |



Access Access with Parking Boat Livery
Drawn by: J. Roth

SPECIES OF FISH	ABUNDANCE		
	Abundant	Common	Present
Muskie			X
N. Pike			X
Walleye	X		
L. M. Bass			X
S. M. Bass			X
Panfish			X
Trout			X

WATER AREA 571.8 ACRES
UNDER 3 FT. 6 %
OVER 20 FT. 37 %
MAX. DEPTH 34 FEET.
TOTAL ALK. 39 P.P.M.
VOLUME 9,311.4 ACRE FT.
SHORELINE 4.79 MILES