

WISCONSIN CONSERVATION DEPARTMENT

LAKE SURVEY MAP

EAGLE SPRINGS
LAKE

WAUKESHA
COUNTY

SEC. 25, 26, 35, 36 T. 5 N. R. 17 E. W.

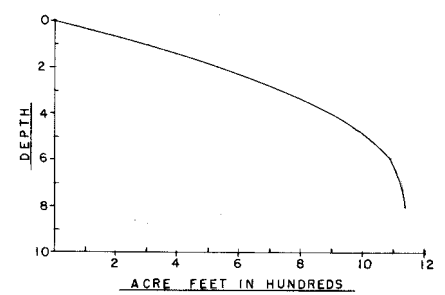
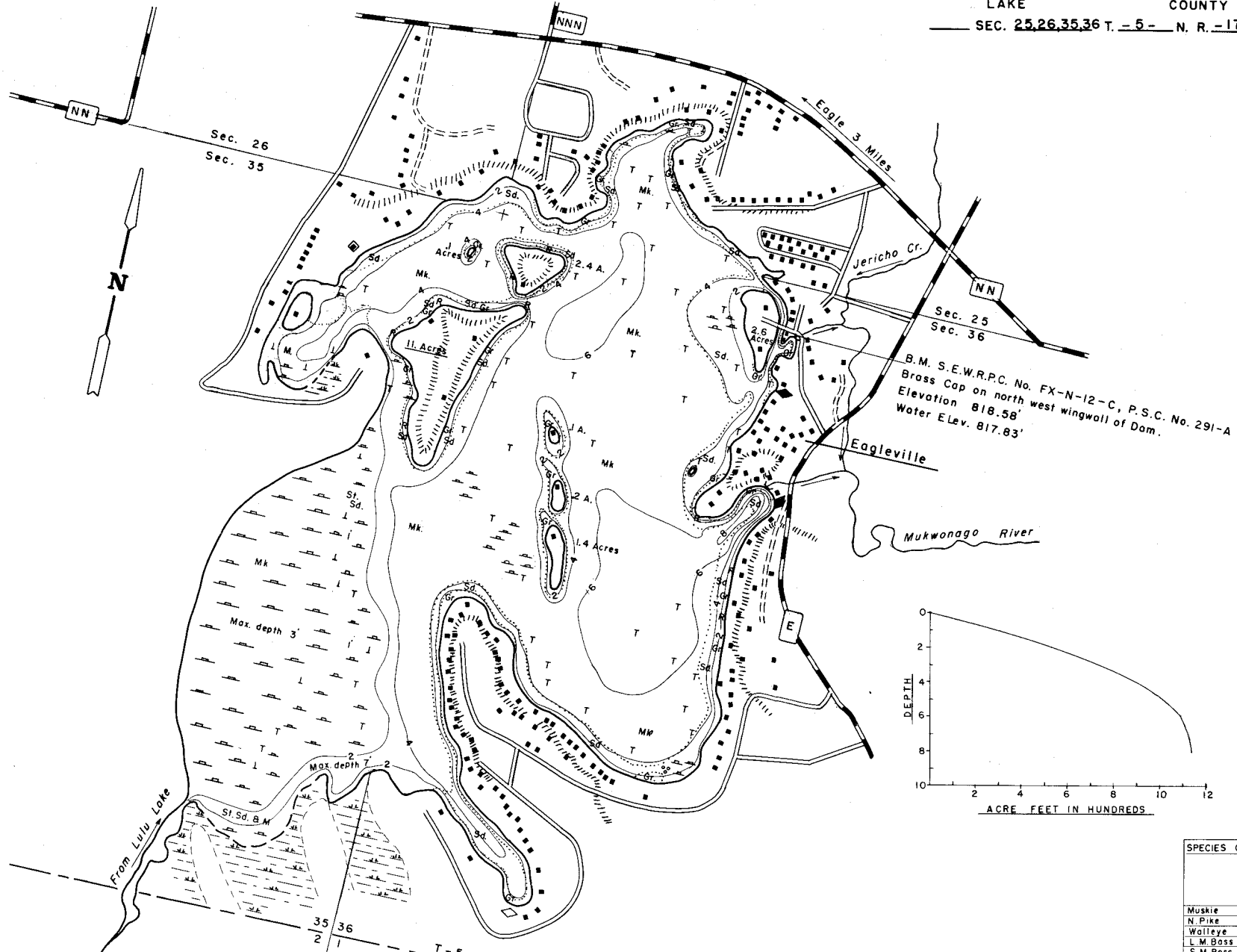

EQUIPMENT ECHO SOUNDER MAPPED AUGUST 1967
MO. YR.

- TOPOGRAPHIC SYMBOLS
- (B) Brush
 - (PW) Partially wooded
 - (W) Wooded
 - (C) Cleared
 - (P) Pastured
 - (A) Agricultural
 - B.M. Bench Mark

- LAKE BOTTOM SYMBOLS
- Steep slope
 - Indefinite shoreline
 - Marsh
 - Spring
 - Intermittent stream
 - Permanent inlet
 - Permanent outlet
 - P. Peat
 - Mk. Muck
 - C. Clay
 - M. Marl
 - Gr. Gravel
 - R. Rubble
 - Br. Bedrock
 - T. Submergent vegetation
 - Stumps & Snags

WATER ELEV. 817.83

WAUKESHA CO.
WALWORTH CO.

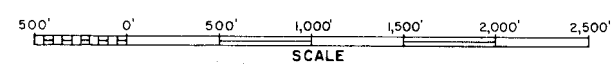

SPECIES OF FISH	Abundance	
	Common	Rare
Muskie		
N. Pike		X
Walleye		
L.M. Bass		X
S.M. Bass		
Panfish	X	
Trout		

326.0 WITH ISLANDS
AREA 310.5 ACRES
UNDER 3 FT. 22 %
OVER 20 FT. 0 %
VOLUME 1,126.9 ACRE FT.
TOTAL ALK. 184 PPM
SHORELINE 6.7 WITH ISLANDS MILES