

STATE OF WISCONSIN
DEPARTMENT OF NATURAL RESOURCES

LAKE SURVEY MAP

CYCLE LAKE ASHLAND COUNTY
SEC. 25 T. -42- N. R. -1- E.W.

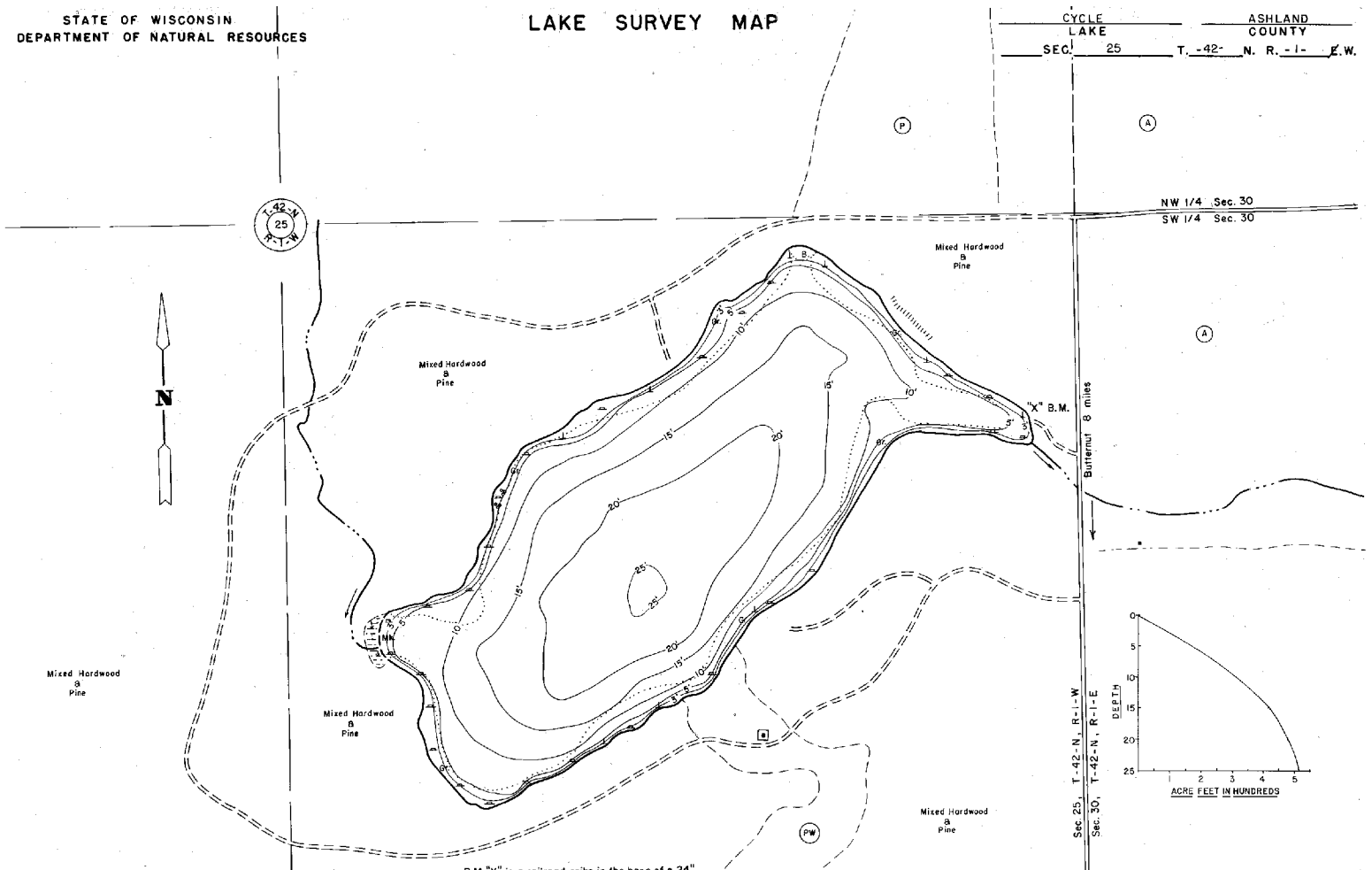

NW 1/4 Sec. 30
SW 1/4 Sec. 30

Butternut 8 miles
Sec. 25, T. -42-N, R. -1-W
Sec. 30, T. -42-N, R. -1-E

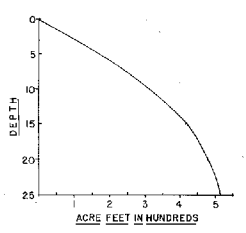

EQUIPMENT RECORDING SONAR MAPPED	AUGUST	1977
TOPOGRAPHIC SYMBOLS	LAKE BOTTOM	SYMBOLS
Brush	Steep slope	P. Peat
Partially wooded	Indefinite shoreline	Mk Muck
Wooded	Marsh	C. Clay
Cleared	Spring	M. Marl
Pastured	Intermittent stream	Sd. Sand
Agricultural	Permanent inlet	St. Silt
B.M. Bench Mark	Permanent outlet	Gr. Gravel
Dwelling	Dam	R. Rubble
Resort	D.N.R. State owned land	Bc Bedrock
Camp		

B.M. "X" is a railroad spike in the base of a 24" White Pine, located at the N.E. side of lake 105' N. of outlet and 17' E. of lake. Assumed elevation = 100.00' Water level = 97.10'

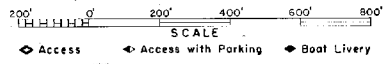

Access Access with Parking Boat Livery
Drawn by: R. Williams
Field work by: C. Busch, K. Cable, L. Sather

SPECIES OF FISH	ABUNDANT	PRESENT
Muskie		
N. Pike		
Walleye	X	
L. W. Bass	X	
S. W. Bass		
Panfish	X	
Trout		

WATER AREA 36.5 ACRES
UNDER 3 FT. 7 %
OVER 20 FT. 21 %
MAX. DEPTH 25 FEET
TOTAL ALK. 11 P.P.M.
VOLUME 500.15 ACRE FT.
MAIN SHORELINE 1.15 MI.
ISLAND SHORELINE 0 MI.

Maps are not for navigation
Source-Wisconsin Department of Natural Resources
Hunt Fish Camp Wisconsin .Com 2005