

STATE OF WISCONSIN
DEPARTMENT OF NATURAL RESOURCES

LAKE SURVEY MAP

CRYSTAL LAKE BARRON COUNTY
SEC. 28, 33 T. 35 N. R. 14 W.

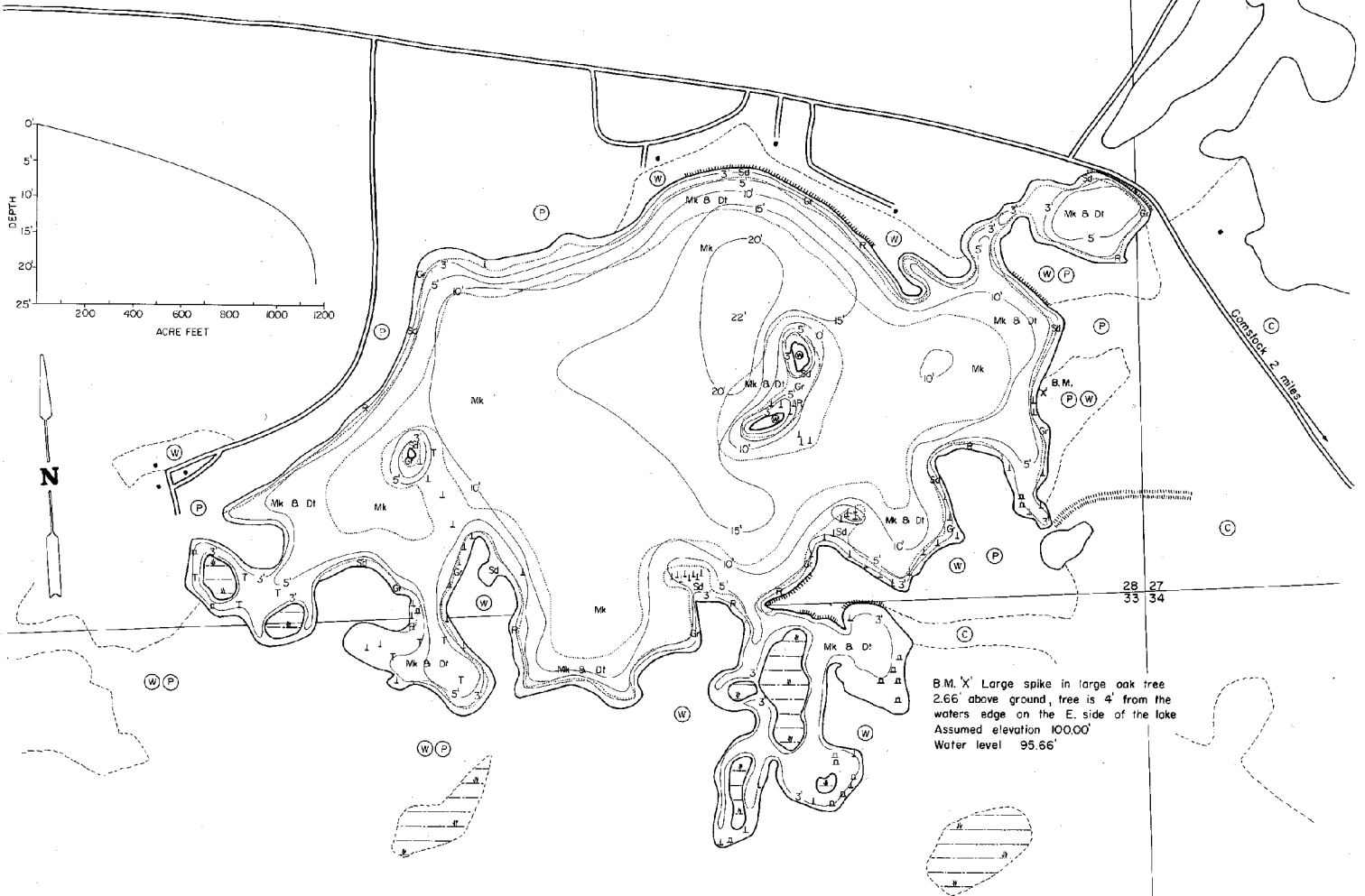

B.M. X Large spike in large oak tree
2.66' above ground, tree is 4' from the
waters edge on the E. side of the lake
Assumed elevation 100.00'
Water level 95.66'

- EQUIPMENT SONAR & POLE MAPPED AUG 1972
- TOPOGRAPHIC SYMBOLS
- (B) Brush
 - (W) Partly wooded
 - (C) Cleared
 - (P) Pastured
 - (A) Agricultural
 - B.M. Bench Mark
 - Dwelling
 - Resort
 - Camp
- LAKE BOTTOM SYMBOLS
- P Peat
 - Mk Muck
 - C Clay
 - M Marl
 - Sd Sand
 - Sl Silt
 - Gr Gravel
 - R Rubble
 - Br Bedrock
 - B Boulders
 - Slumps & Snags
 - Rock danger to navigation
 - Emergent vegetation
 - Floating vegetation
 - Brush shelters
 - Detritus

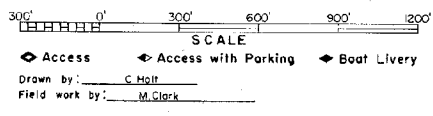

SPECIES OF FISH	ABUNDANCE		
	Abundant	Common	Present
Muskie			
N. Pike	X		
Walleye			X
L. N. Bass			X
S. M. Bass			X
Panfish	X		
Trout			X

WATER AREA 120.0 ACRES
UNDER 3 FT. 14 %
OVER 20 FT. 3 %
MAX. DEPTH 22 FEET.
TOTAL ALK. 11 P.P.M.
VOLUME 1159 ACRE FT.
SHORELINE 3.98 MILES
SHORELINE 4.79 MILES WITH IS.

Maps are not for navigation
Source-Wisconsin Department of Natural Resources
Hunt Fish Camp Wisconsin .Com 2005