

STATE OF WISCONSIN  
DEPARTMENT OF NATURAL RESOURCES

LAKE SURVEY MAP

CRAWLING STONE LAKE  
VILAS COUNTY  
SEC. 16, 17, 18, 19, 20, 21, 28 T. 40 - N. R. 5 - E.  
Section 17  
Section 16  
29  
Sheet 1 of 2 sheets

LONG INTERLAKEN LAKE  
368 ACRES  
MAXIMUM DEPTH 65'

2 Miles to Lac du Flambeau

Department of Natural Resources Bench Mark 1176-A is a bronze tablet set in top of concrete post 29' southeast of centerline of County Trunk Highway 'D', between Big Crawling Stone and Long Interlaken lakes. Elevation 100.00' Water elevation 91.40'

Section 18  
Section 19

Section 16  
Section 21

LITTLE CRAWLING STONE LAKE  
116 ACRES  
MAXIMUM DEPTH 48'

EQUIPMENT RECORDING SONAR MAPPED APRIL 1968

- TOPOGRAPHIC SYMBOLS
- (B) Brush
  - (PW) Partially wooded
  - (W) Wooded
  - (C) Cleared
  - (P) Pastured
  - (A) Agricultural
  - B.M. Bench Mark
  - (D) Dwelling
  - (B) Basalt
  - (D.N.P) State owned land
  - (S) Steep slope
  - (I) Indefinite shoreline
  - (M) Marsh
  - (S) Spring
  - (I) Intermittent stream
  - (P) Permanent inlet
  - (O) Permanent outlet
  - (D) Dam
  - (S) State owned land
  - P. Peat
  - Mk. Muck
  - C. Clay
  - M. Marl
  - Sd. Sand
  - Sl. Silt
  - Gr. Gravel
  - R. Rubble
  - R. Redrock

- LAKE BOTTOM SYMBOLS
- B Boulders
  - Mk. Stumps & Snags
  - Rock danger to navigation
  - T Submergent vegetation
  - L Emergent vegetation
  - F Floating vegetation
  - Brush shelters



Access Access with Parking Boat Livery

SPECIES OF FISH

	Abundant	Common	Present
Muskie			X
N. Pike			X
Wolleye	X	X	X
L. M. Bass	X	X	X
S. M. Bass	X	X	X
Panfish	X	X	X
Trout	X	X	X

WATER AREA 1466 ACRES  
UNDER 3 FT. 10 %  
OVER 20 FT. 61 %  
MAX. DEPTH 87 FEET.  
TOTAL ALK. 34 P.P.M.  
VOLUME 45694 ACRE FT.  
SHORELINE 9.5 MILES

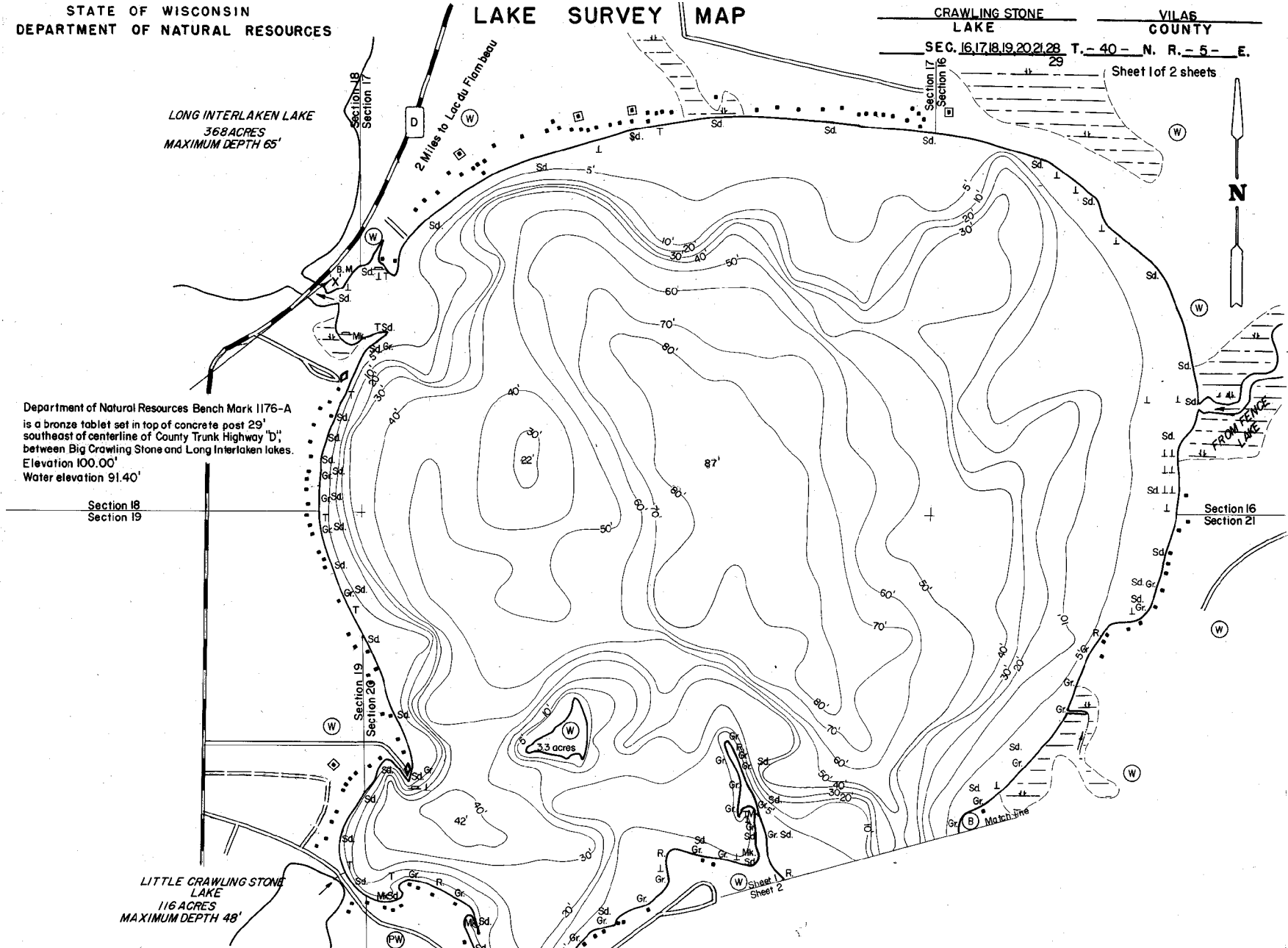
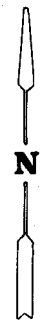

Drawn by: J. Rath