

STATE OF WISCONSIN
DEPARTMENT OF NATURAL RESOURCES

LAKE SURVEY MAP

CRANBERRY LAKE
DOUGLAS COUNTY
SEC. 19, 24, 25 T. 43 N. R. 12, 13 W.

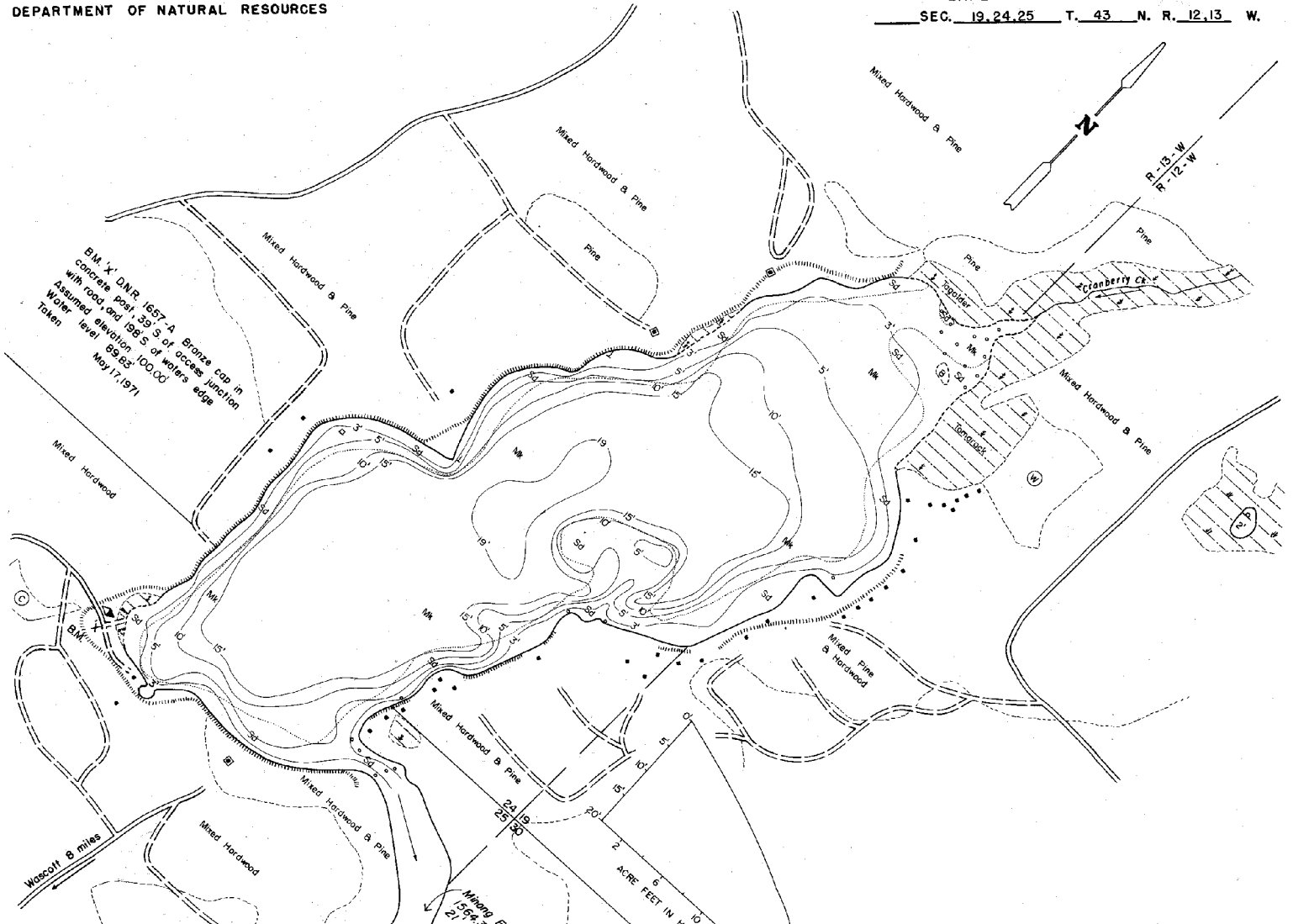

B.M. 'X' D.N.R. 1657-A Bronze cap in concrete post, 33' S of access junction with road, road 184' S of water's edge. Assumed elevation 194' S of water's edge. Water level 89.63' 100.00'. Taken May 17, 1971

- EQUIPMENT RECORDING SONAR MAPPED MAY 1971
- TOPOGRAPHIC SYMBOLS
- (B) Brush
 - (W) Partly wooded
 - (C) Cleared
 - (P) Pastured
 - (A) Agricultural
 - B.M. Bench Mark
 - Dwelling
 - Resort
 - Camp
- LAKE BOTTOM SYMBOLS
- P. Peat
 - Mk. Muck
 - C. Clay
 - M. Marl
 - Sd. Sand
 - Sl. Silt
 - Gr. Gravel
 - R. Rubble
 - Bg. Bedrock

- LAKE BOTTOM SYMBOLS
- B Boulders
 - Stumps & Snags
 - Rock danger to navigation
 - T Submergent vegetation
 - Emergent vegetation
 - Floating vegetation
 - Brush shelters

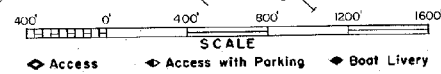

Access Access with Parking Boot Livery

Drawn by: C. Hall

Field work by: C. Busch, G. Lund, L. Sather

SPECIES OF FISH	ABUNDANCE		
	Abundant	Common	Present
Muskie			
N. Pike	X		
Walleye	X		
L. M. Bass	X		
S. M. Bass			
Pontfish	X		
Trout			

WATER AREA 1716 ACRES

UNDER 3 FT. 15 %

OVER 20 FT. 0 %

MAX. DEPTH 19 FEET.

TOTAL ALK. 35 P.P.M.

VOLUME 1838 ACRE FT.

SHORELINE 2.76 MILES

Maps are not for navigation
Source-Wisconsin Department of Natural Resources
Hunt Fish Camp Wisconsin .Com 2005