

STATE OF WISCONSIN  
DEPARTMENT OF NATURAL RESOURCES

LAKE SURVEY MAP

CONNORS LAKE SAWYER COUNTY  
SEC. 22,27,28 T.-38-N. R.-3-W.  
(Sheet 1 of 2)

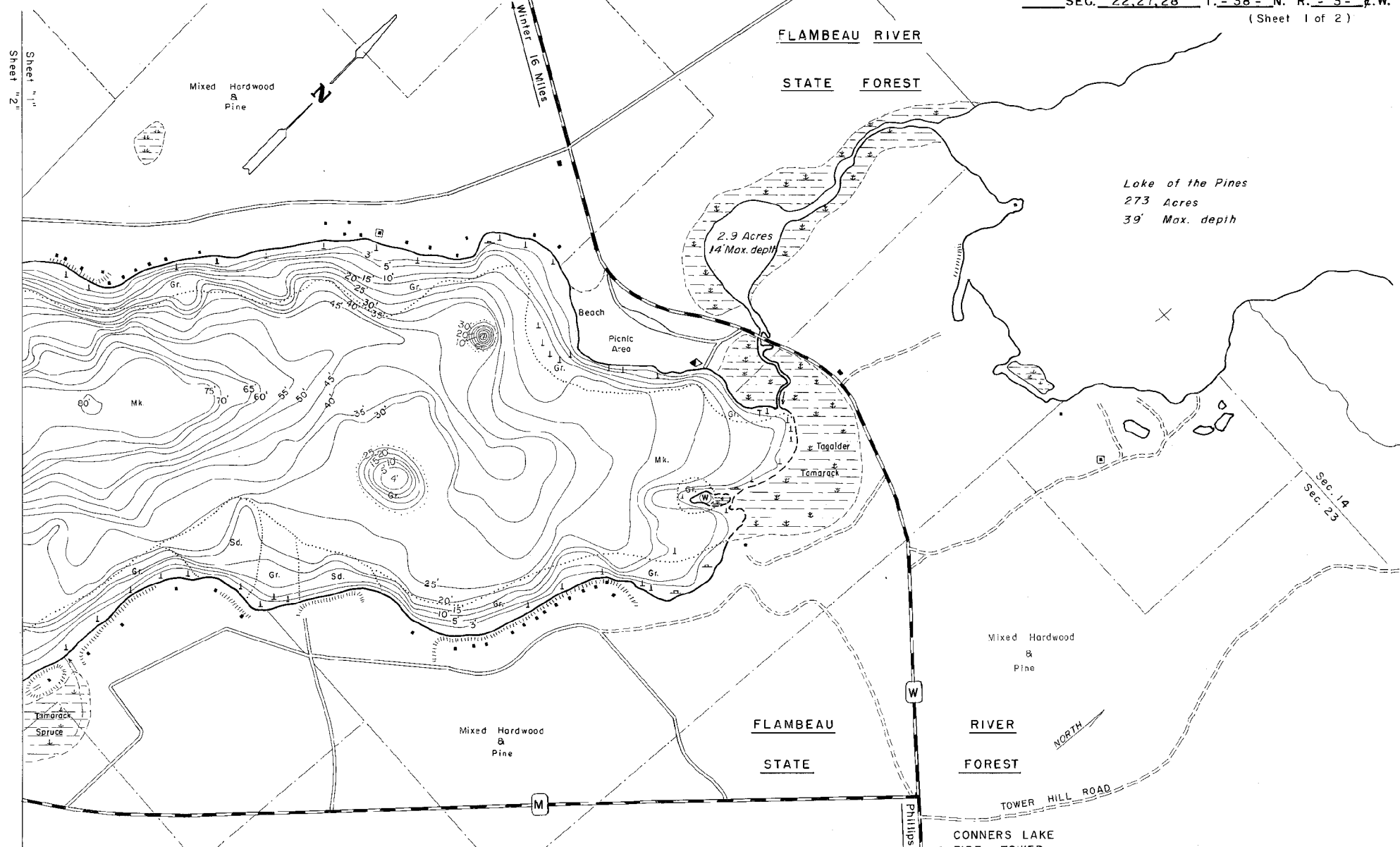

REVISOR: JUNE 1985  
EQUIPMENT RECORDING SONAR MAPPED MONTH YEAR

TOPOGRAPHIC SYMBOLS		LAKE BOTTOM SYMBOLS	
(B) Brush	Steep slope	P. Peat	B Boulders
(PW) Partially wooded	- - - Indefinite shoreline	Mk. Muck	⊙ Stumps & Snags
(W) Wooded	⊘ Marsh	C. Clay	⊙ Rock danger to navigation
(C) Cleared	⊙ Spring	M. Marl	T Submergent vegetation
(P) Pastured	- - - Intermittent stream	Sd. Sand	⊙ Emergent vegetation
(A) Agricultural	⊙ Permanent inlet	St. Silt	⊙ Floating vegetation
B.M. Bench Mark	⊙ Permanent outlet	Gr. Gravel	⊙ Brush shelters
■ Dwelling	⊙ Dam	R. Rubble	
□ Resort	D.N.R. State owned land	Br. Bedrock	
■ Camp			



Access Access with Parking Boat Livery  
Drawn by: E. Eaton  
Field work by: C. Busch, K. Cable, J. Sather

SPECIES OF FISH	Abundance		
	Common	Present	
Muskie	X	X	
N. Pike	X	X	
Walleye	X	X	
L.M. Bass	X	X	
S.M. Bass	X	X	
Panfish	X	X	
Trout			

WATER AREA 429.0 ACRES  
UNDER 3 FT. 7 %  
OVER 20 FT. 72 %  
MAX. DEPTH 82 FEET.  
TOTAL ALK. 42 P.P.M.  
VOLUME 16,074 ACRE FT.  
MAIN SHORELINE 4.66 MI.  
ISLAND SHORELINE .30 MI.