

STATE OF WISCONSIN
DEPARTMENT OF NATURAL RESOURCES

LAKE SURVEY MAP

CLEAR LAKE ONEIDA COUNTY
SEC. 9, 10, 15, 16, 17, 21 T. 39 N. R. 7 E.
SHEET 1 OF 3

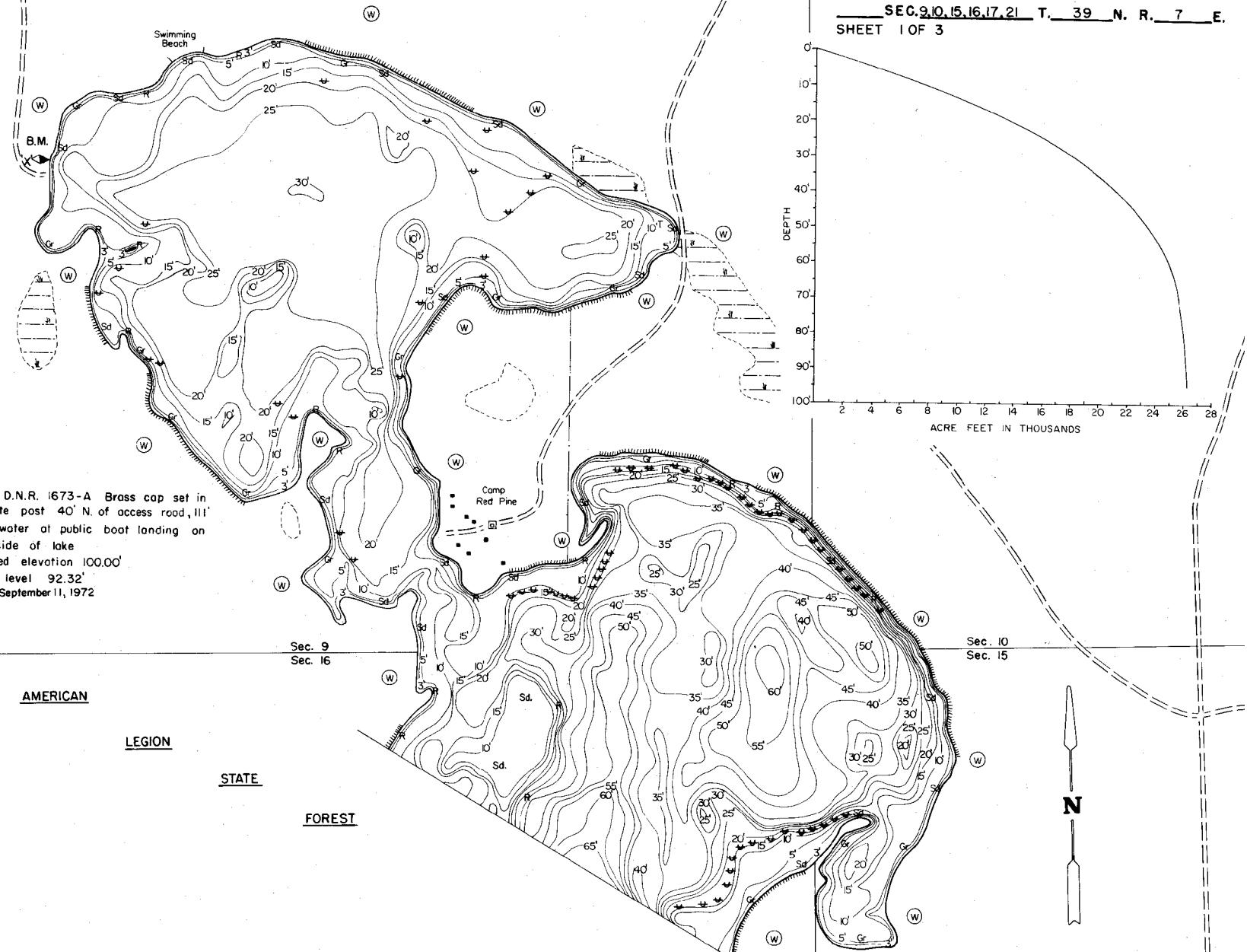

B.M. X D.N.R. 1673-A Brass cap set in concrete post 40' N. of access road, 111' W. of water at public boat landing on N.W. side of lake
Assumed elevation 100.00'
Water level 92.32'
Taken September 11, 1972

AMERICAN
LEGION
STATE
FOREST

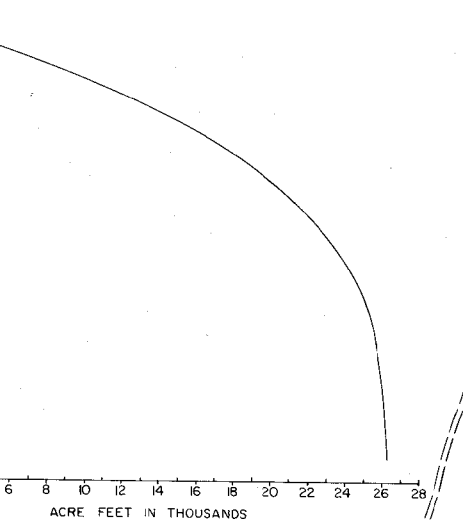

EQUIPMENT RECORDING SONAR MAPPED JULY 1973

- | TOPOGRAPHIC SYMBOLS | | LAKE BOTTOM SYMBOLS | |
|---------------------|----------------------|---------------------|---------------------------|
| (B) Brush | Steep slope | P. Peat | B Boulders |
| (PW) Partly wooded | Indefinite shoreline | Mk. Muck | Stumps & Snags |
| (W) Wooded | Marsh | C. Clay | Rock danger to navigation |
| (C) Cleared | Spring | M. Marl | T Submergent vegetation |
| (P) Pastured | Intermittent stream | Sd. Sand | I Emergent vegetation |
| (A) Agricultural | Permanent inlet | Sl. Silt | F Floating vegetation |
| B.M. Bench Mark | Permanent outlet | Gr. Gravel | BS Brush shelters |
| ■ Dwelling | Dam | R. Rubble | |

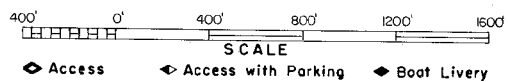

SPECIES OF FISH	Abundance		
	Abundant	Common	Present
Muskie			X
N. Pike			X
Walleye	X		
L. M. Bass	X		
S. M. Bass	X		

WATER AREA 845.8 ACRES
UNDER 3 FT. 3 %
OVER 20 FT. 62 %
MAX. DEPTH 95 FEET.
TOTAL ALK. 10 P.P.M.
VOLUME 26,206 ACRE FT.