

STATE OF WISCONSIN
DEPARTMENT OF NATURAL RESOURCES

LAKE SURVEY MAP

CHINTY LAKE WASHBURN COUNTY
SEC. 28, 29 T. 38 N. R. 11 W.

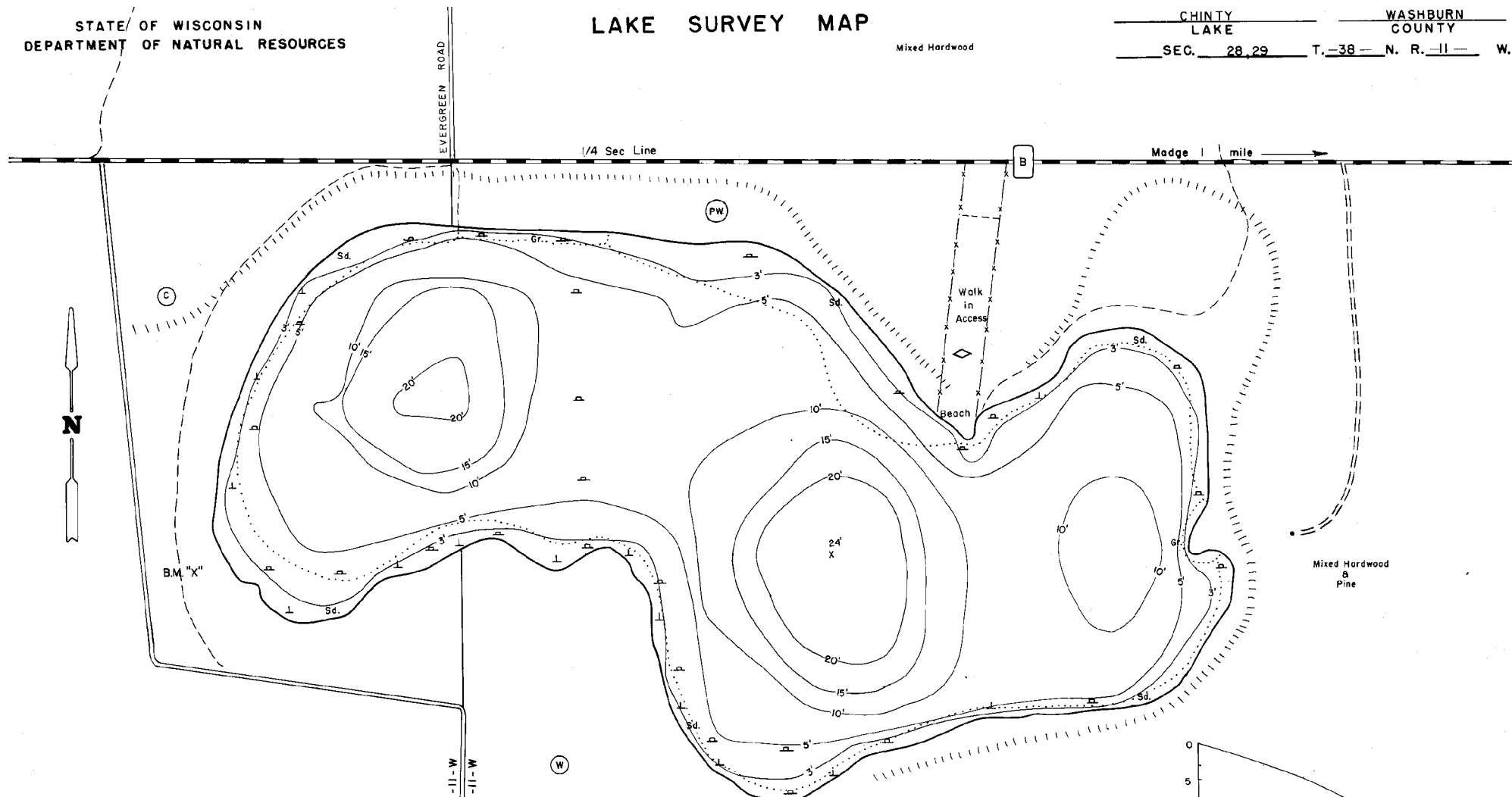

B.M. "X" is a railroad spike in the base of a power-pole located 54' west of lake and 76' E. of town rd.
Assumed elevation = 100.00'
Water level = 93.68'

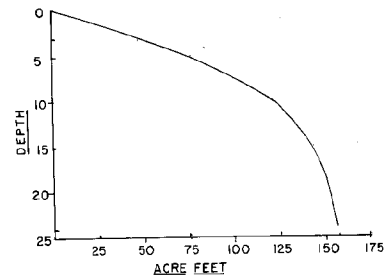

EQUIPMENT RECORDING SONAR MAPPED SEPT. 1977

TOPOGRAPHIC SYMBOLS	LAKE BOTTOM SYMBOLS
Brush	P. Peat
Partially wooded	Mk. Muck
Wooded	C. Clay
Cleared	M. Marl
Pastured	Sd. Sand
Agricultural	St. Silt
B.M. Bench Mark	Gr. Gravel
Dwelling	R. Rubble
Resort	Br. Bedrock
Camp	B. Boulders
	Stumps & Snags
	Rock danger to navigation
	Submergent vegetation
	Emergent vegetation
	Floating vegetation
	Brush shelters



Access Access with Parking Boat Livery
Drawn by: R. Williams
Field work by: G. Busch, K. Cable, L. Sother

SPECIES OF FISH	Abundance	
	Common	Present
Muskie		
N. Pike		
Walleye		
L.M. Boss	X	
S.M. Boss		
Panfish	X	
Trout		

WATER AREA 17.5 ACRES
UNDER 3 FT. 11 %
OVER 20 FT. 7 %
MAX. DEPTH 24 FEET.
TOTAL ALK. 10 P.P.M.
VOLUME 156.25 ACRE FT.
MAIN SHORELINE 0.8 MI.
ISLAND SHORELINE 0 MI.