

STATE OF WISCONSIN
DEPARTMENT OF NATURAL RESOURCES

LAKE SURVEY MAP

CALDRON FALLS RESERVOIR MARINETTE COUNTY
LAKE
SEC. 3,4,5,6,8,9,10 T.-33- N. R.-18- E.##
(Sheet 2 of 2)

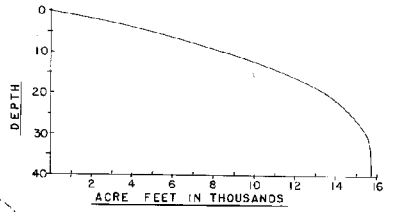
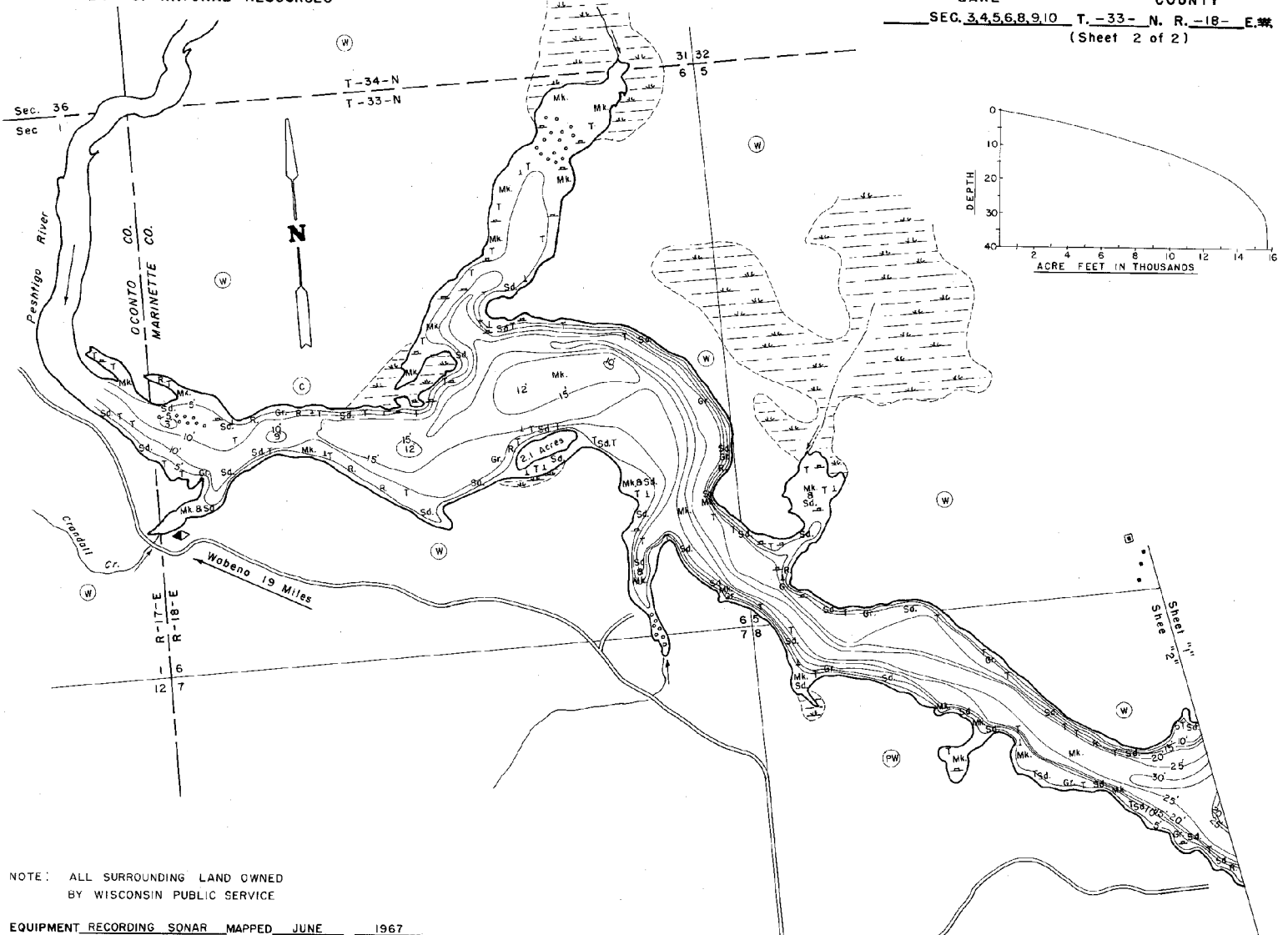

NOTE: ALL SURROUNDING LAND OWNED BY WISCONSIN PUBLIC SERVICE

EQUIPMENT RECORDING SONAR MAPPED	MONTH	YEAR
TOPOGRAPHIC SYMBOLS	LAKE BOTTOM	SYMBOLS
(B) Brush	P. Peat	B Boulders
(PW) Partially wooded	Mk. Muck	☼ Slumps & Snags
(W) Wooded	C. Clay	⊗ Rock danger to navigation
(C) Cleared	M. Marl	T Submergent vegetation
(P) Pastured	Sd. Sand	⊥ Emergent vegetation
(A) Agricultural	Sl. Silt	⊕ Floating vegetation
B.M. Bench Mark	Gr. Gravel	⊕ Brush shelters
■ Dwelling	R. Rubble	
□ Resort	Br. Bedrock	
⊠ Camp		

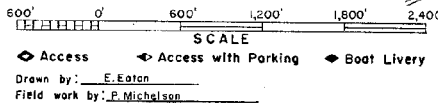

SPECIES OF FISH	ABUNDANCE		
	Abundant	Common	Present
Muskie	X		
N. Pike	X		
Wolleye		X	X
L.M. Bass	X		
S.M. Bass	X		
Panfish	X		
Trout			

WATER AREA 1,018.0 ACRES
UNDER 3 FT. 10 %
OVER 20 FT. 26 %
MAX. DEPTH 40 FEET.
TOTAL ALK. 61 P.P.M.
VOLUME 15,656.0 ACRE FT.
SHORELINE 21 MILES
WITH ISLANDS 22.6 MILES

Maps are not for navigation
Source-Wisconsin Department of Natural Resources
Hunt Fish Camp Wisconsin .Com 2005