

STATE OF WISCONSIN
DEPARTMENT OF NATURAL RESOURCES

LAKE SURVEY MAP

CALDRON FALLS RESERVOIR
LAKE
MARINETTE COUNTY
SEC. 3, 4, 5, 6, 8, 9, 10 T. - 33 - N. R. - 18 - E.
(Sheet 1 of 2)

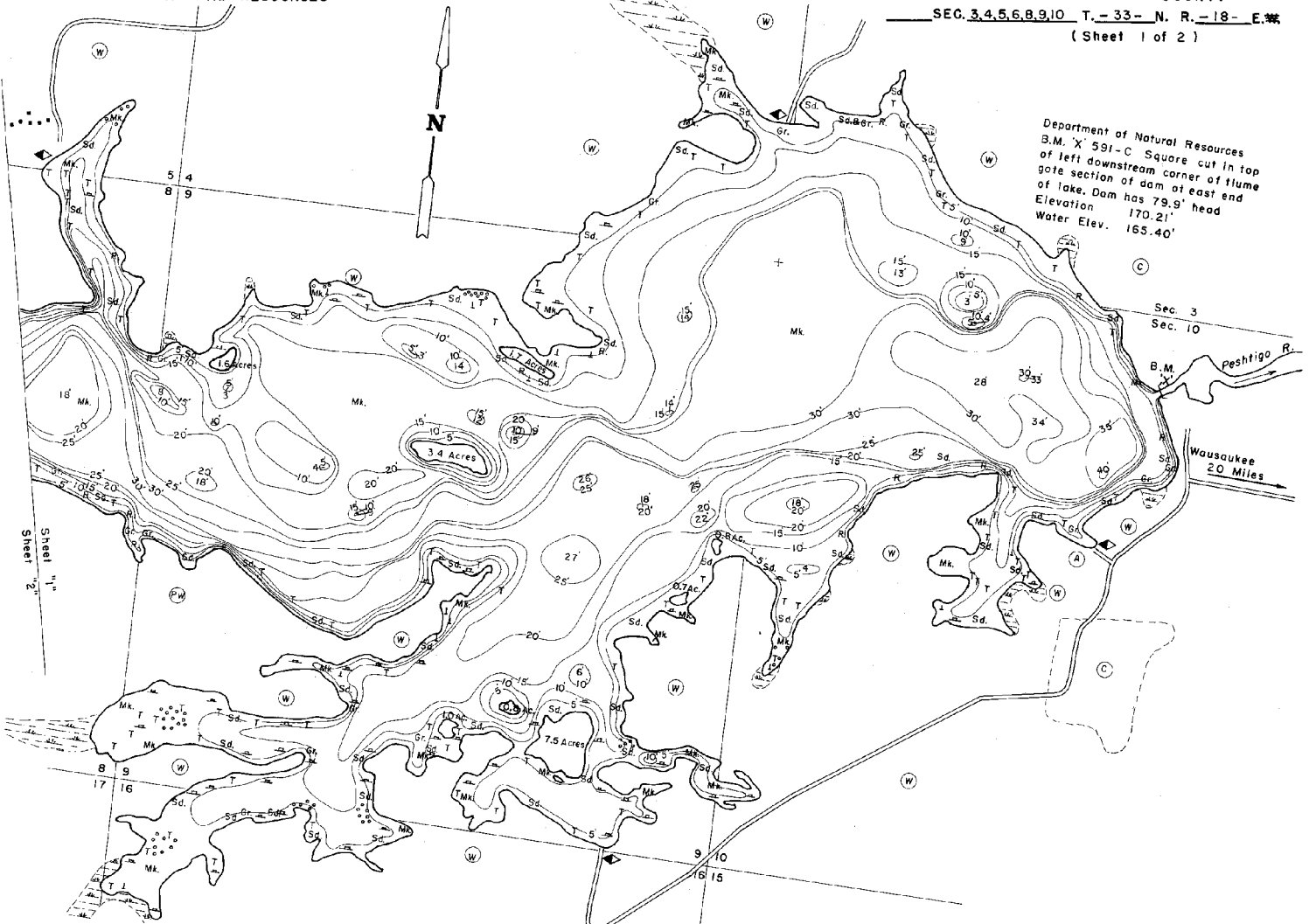

Department of Natural Resources
B.M. X 591-C Square cut in top
gate section of dam at east end
of lake. Dam has 79.9' head
Elevation 170.21'
Water Elev. 165.40'

EQUIPMENT RECORDING SONAR MAPPED JUNE 1967
MONTH YEAR

- | TOPOGRAPHIC SYMBOLS | | LAKE BOTTOM SYMBOLS | |
|----------------------|---------------------------|---------------------|---------------------------|
| (B) Brush | (S) Steep slope | P. Peat | B Boulders |
| (W) Partially wooded | (I) Indefinite shoreline | Mx. Muck | Stumps & Snags |
| (W) Wooded | (M) Marsh | C. Clay | Rock danger to navigation |
| (C) Cleared | (S) Spring | M. Marl | T Submergent vegetation |
| (P) Pastured | (IS) Intermittent stream | Sd. Sand | I Emergent vegetation |
| (A) Agricultural | (PI) Permanent inlet | Sl. Silt | F Floating vegetation |
| B.M. Bench Mark | (PO) Permanent outlet | Gr. Gravel | BS Brush shelters |
| (D) Dwelling | (D) Dam | R. Rubble | |
| (R) Resort | (D.N.R.) State owned land | Bc Bedrock | |
| (C) Camp | | | |



Access Access with Parking Boat Livery
Drawn by: E. Eaton
Field work by: P. Michelson

SPECIES OF FISH	ABUNDANCE	
	Present	Not Present
Muskie	X	
N. Pike	X	
Walleye	X	
L.M. Bass	X	
S.M. Bass	X	
Panfish	X	
Trot		

WATER AREA 1,018.0 ACRES
UNDER 3 FT. 10 %
OVER 20 FT. 26 %
MAX. DEPTH 40 FEET.
TOTAL ALK. 61 P.P.M.
VOLUME 15,656.0 ACRE FT.
SHORELINE 21 MILES
WITH ISLANDS 22.6 MILES

Maps are not for navigation
Source-Wisconsin Department of Natural Resources
Hunt Fish Camp Wisconsin .Com 2005