

STATE OF WISCONSIN
DEPARTMENT OF NATURAL RESOURCES

LAKE SURVEY MAP

CASTLE ROCK FLOWAGE ADAMS JUNEAU
LAKE COUNTY
SEC. AS SHOWN T-16, 17, 18-N. R. -4, 5 - E. 1/4
(Sheet 3 of 3)

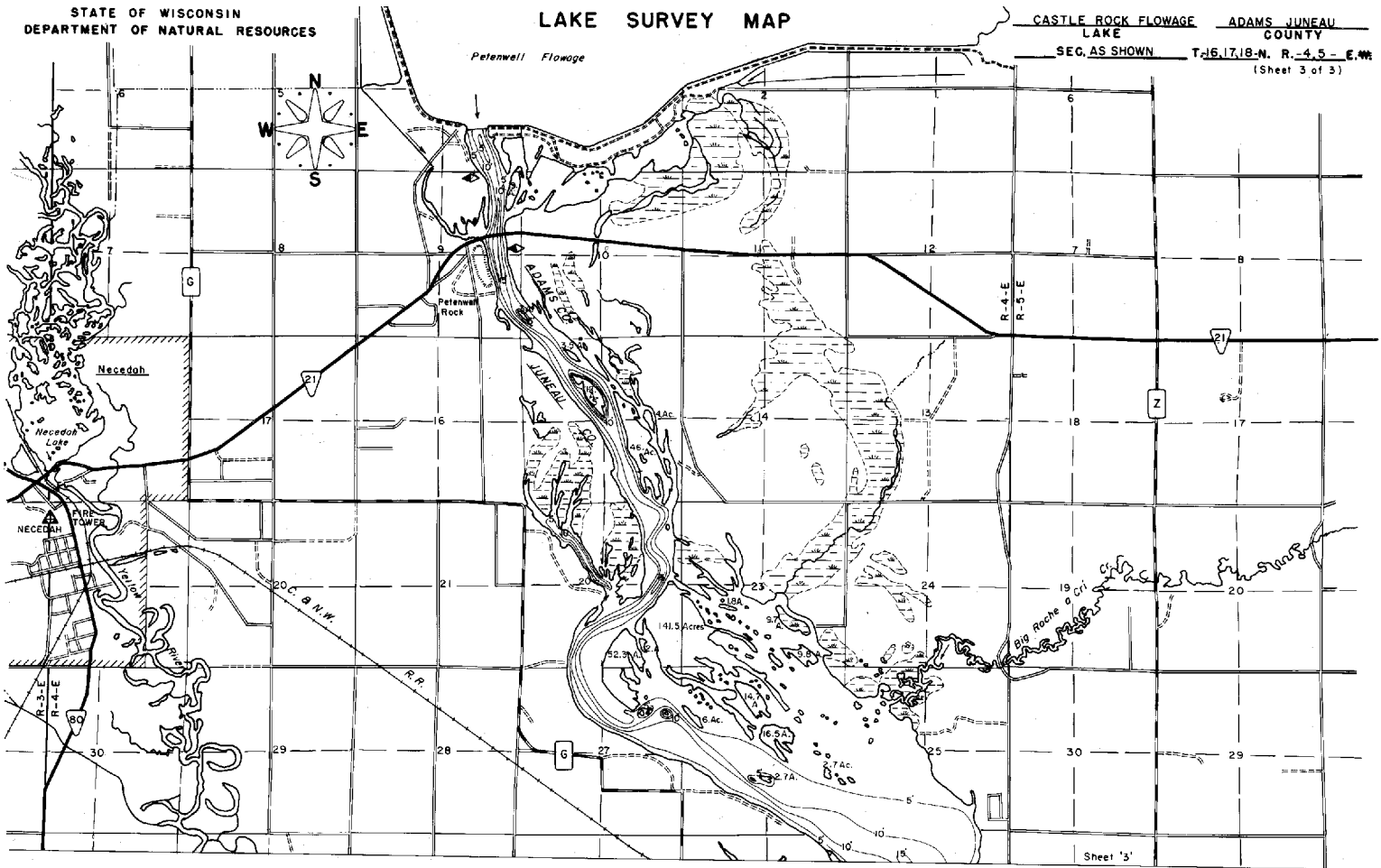

EQUIPMENT RECORDING SONAR MAPPED	SUMMER MONTH	1974 YEAR
TOPOGRAPHIC SYMBOLS	LAKE BOTTOM SYMBOLS	
(B) Brush	iiiiiii Steep slope	P. Peat
(P) Partially wooded	~ Indefinite shoreline	Mk. Muck
(W) Wooded	~ Marsh	C. Clay
(C) Cleared	~ Spring	M. Muck
(P) Pastured	~ Intermittent stream	Sd. Sand
(A) Agricultural	~ Permanent inlet	Sl. Silt
B.M. Bench Mark	~ Permanent outlet	Gr. Gravel
(D) Dwelling	~ Dam	R. Rubble
(R) Resort	~ D.N.R. State owned land	Bc. Bedrock
(C) Camp		
		B. Boulders
		Stumps & Snags
		Rock danger to navigation
		Submergent vegetation
		Emergent vegetation
		Floating vegetation
		Brush shelters

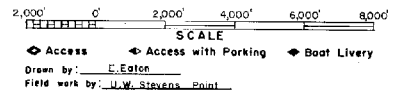

SPECIES OF FISH	Abundance	
	Present	Extinct
Muskie	X	
N. Pike	X	
Walleye	X	
L. M. Bass	X	
S. M. Bass	X	
Panfish	X	
Trot	X	

WATER AREA 13,955.3 ACRES
 UNDER 3 FT. 15 %
 OVER 20 FT. 17 %
 MAX. DEPTH 35 FEET.
 TOTAL ALK. 31 P.P.M.
 VOLUME 172,050.4 ACRE FT.
 MAIN SHORELINE 72.94 MI.
 ISLAND SHORELINE 32.12 MI.

Maps are not for navigation
 Source-Wisconsin Department of Natural Resources
 Hunt Fish Camp Wisconsin .Com 2005