

STATE OF WISCONSIN
DEPARTMENT OF NATURAL RESOURCES

LAKE SURVEY MAP

CAMELOT LAKE
ADAMS COUNTY
SEC. 9, 10, 13, 14, 15 T. 20 N. R. 6 E.
SHEET 3 OF 4

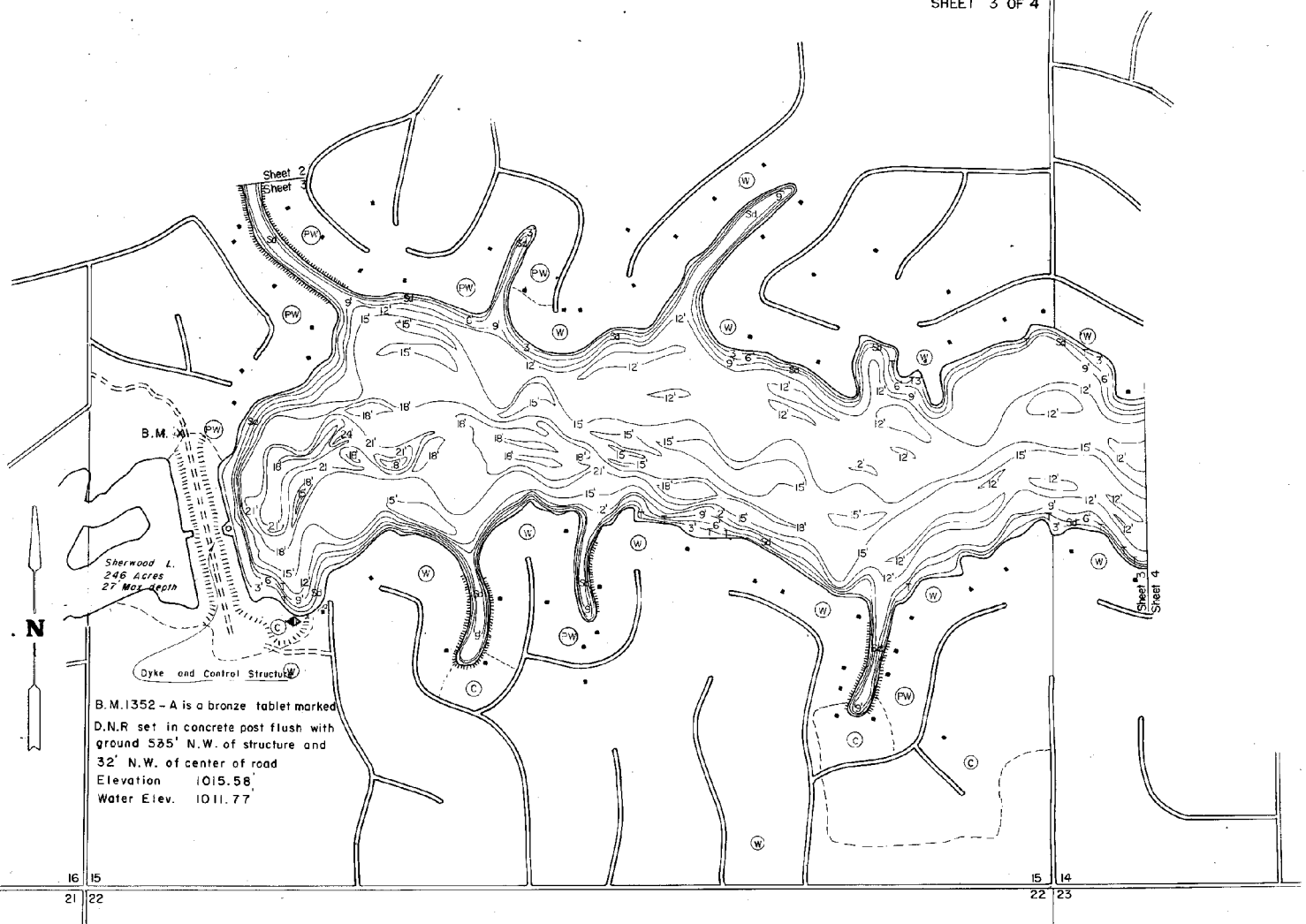

- EQUIPMENT RECORDING SONAR MAPPED AUGUST 1971
- | TOPOGRAPHIC SYMBOLS | | LAKE BOTTOM SYMBOLS | |
|-----------------------|---------------------------|---------------------|-----------------------------|
| (B) Brush | Steep slope | P. Peat | B Boulders |
| (PW) Partially wooded | ~ Indefinite shoreline | Mk. Muck | ⚓ Stumps & Snags |
| (W) Wooded | ~ Marsh | C. Clay | ⚠ Rock danger to navigation |
| (C) Cleared | ~ Spring | M. Marl | T Submergent vegetation |
| (P) Pastured | ~ Intermittent stream | Sd. Sand | J Emergent vegetation |
| (A) Agricultural | ~ Permanent inlet | St. Silt | ⚓ Floating vegetation |
| B.M. Bench Mark | ~ Permanent outlet | Gr. Gravel | ⚓ Brush shelters |
| ■ Dwelling | ~ Dam | R. Rubble | |
| ▣ Resort | ~ D.N.R. State owned land | Br. Bedrock | |
| ▢ Camp | | | |

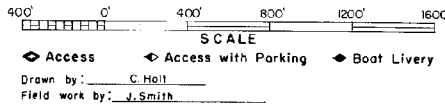

SPECIES OF FISH	Abundance		
	Abundant	Common	Present
Muskie			
N. Pike	X		
Walleye	X		
L. M. Bass	X		
S. M. Bass	X		
Panfish	X		
Trout			

WATER AREA 4450 ACRES
UNDER 3 FT. 19 %
OVER 20 FT. 3 %
MAX. DEPTH 24 FEET.
TOTAL ALK. 153 P.P.M.
VOLUME 4196 ACRE FT.
SHORELINE 18 MILES

Maps are not for navigation
Source-Wisconsin Department of Natural Resources
Hunt Fish Camp Wisconsin .Com 2005