

STATE OF WISCONSIN
DEPARTMENT OF NATURAL RESOURCES

LAKE SURVEY MAP

BOULDER COUNTY
LAKE COUNTY
SEC. 12, 13, 7, 8, 17, 18 T. - 42 - N. R. - 6, 7 - E. 3
(Sheet 1 of 2)

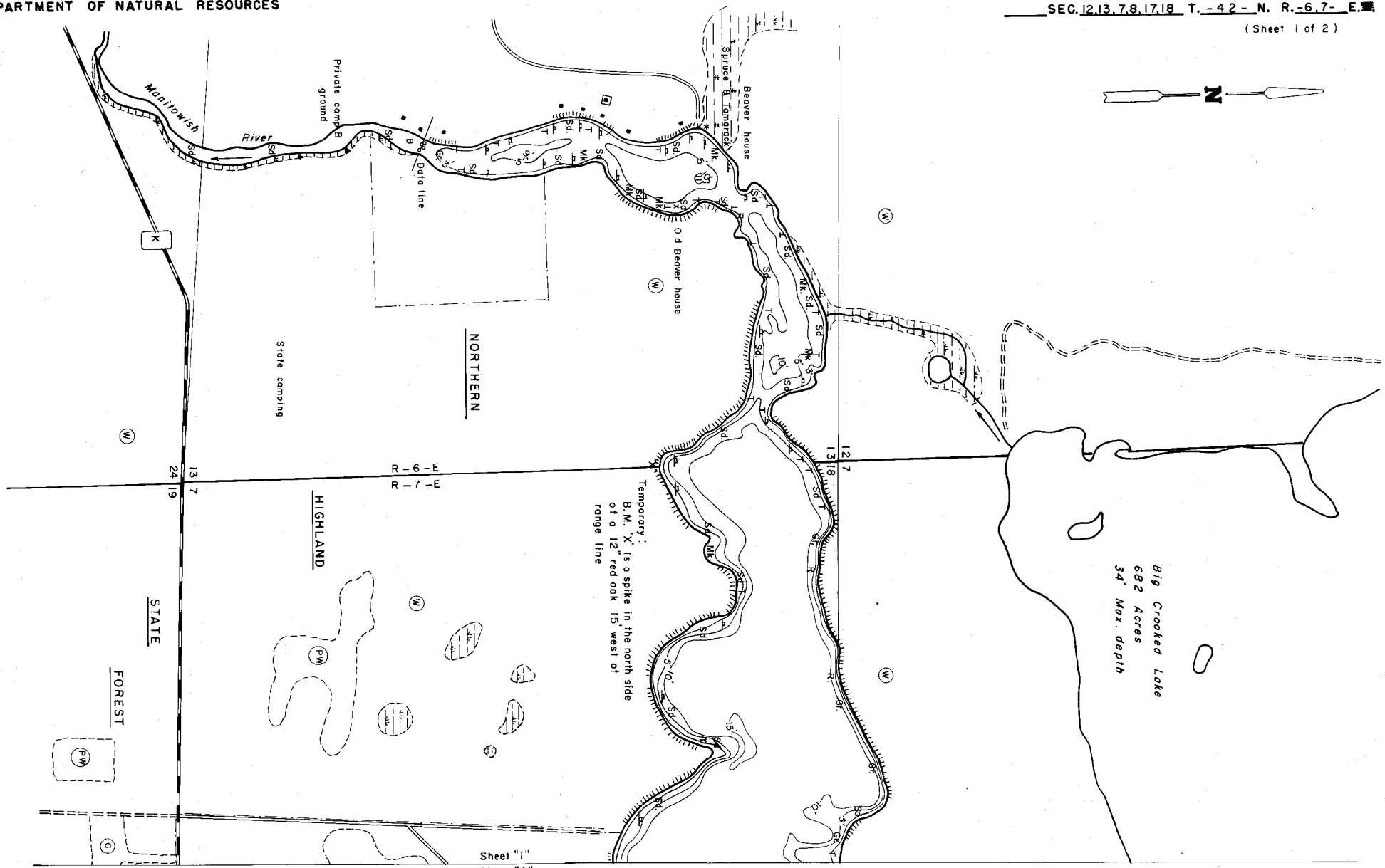

EQUIPMENT RECORDING SONAR MAPPED JUNE 1975

TOPOGRAPHIC SYMBOLS	MONTH LAKE BOTTOM SYMBOLS	YEAR
(B) Brush	P. Peat	1975
(PW) Partially wooded	Mk. Muck	
(W) Wooded	C. Clay	
(C) Cleared	M. Marl	
(A) Pastured	Sd. Sand	
(A) Agricultural	Sl. Silt	
B.M. Bench Mark	Gr. Gravel	
■ Dwelling	R. Rubble	
□ Resort	Br. Bedrock	
□ Camp	B. Boulders	
	Stumps & Snags	
	Rock danger to navigation	
	Submergent vegetation	
	Emergent vegetation	
	Floating vegetation	
	Brush shelters	



Drawn by: E. Eaton
Field work by: J. Smith, R. Theis, K. Kaplan

SPECIES OF FISH	1975	
	Present	Common
Muskie	X	
N. Pike	X	
Walleye	X	
L. M. Bass	X	
S. M. Bass	X	
Panfish	X	
Trout		

WATER AREA 523.7 ACRES
 UNDER 3 FT. 9 %
 OVER 20 FT. 16 %
 MAX. DEPTH 23 FEET.
 TOTAL ALK. 31 P.P.M.
 VOLUME 6,395.8 ACRE FT.
 MAIN SHORELINE 7.50 MI.
 ISLAND SHORELINE .23 MI.