

STATE OF WISCONSIN
DEPARTMENT OF NATURAL RESOURCES

LAKE SURVEY MAP

BIG NEWTON LAKE
MARINETTE COUNTY
SEC. 3 34 T.-33,34-N. R. 19 E.

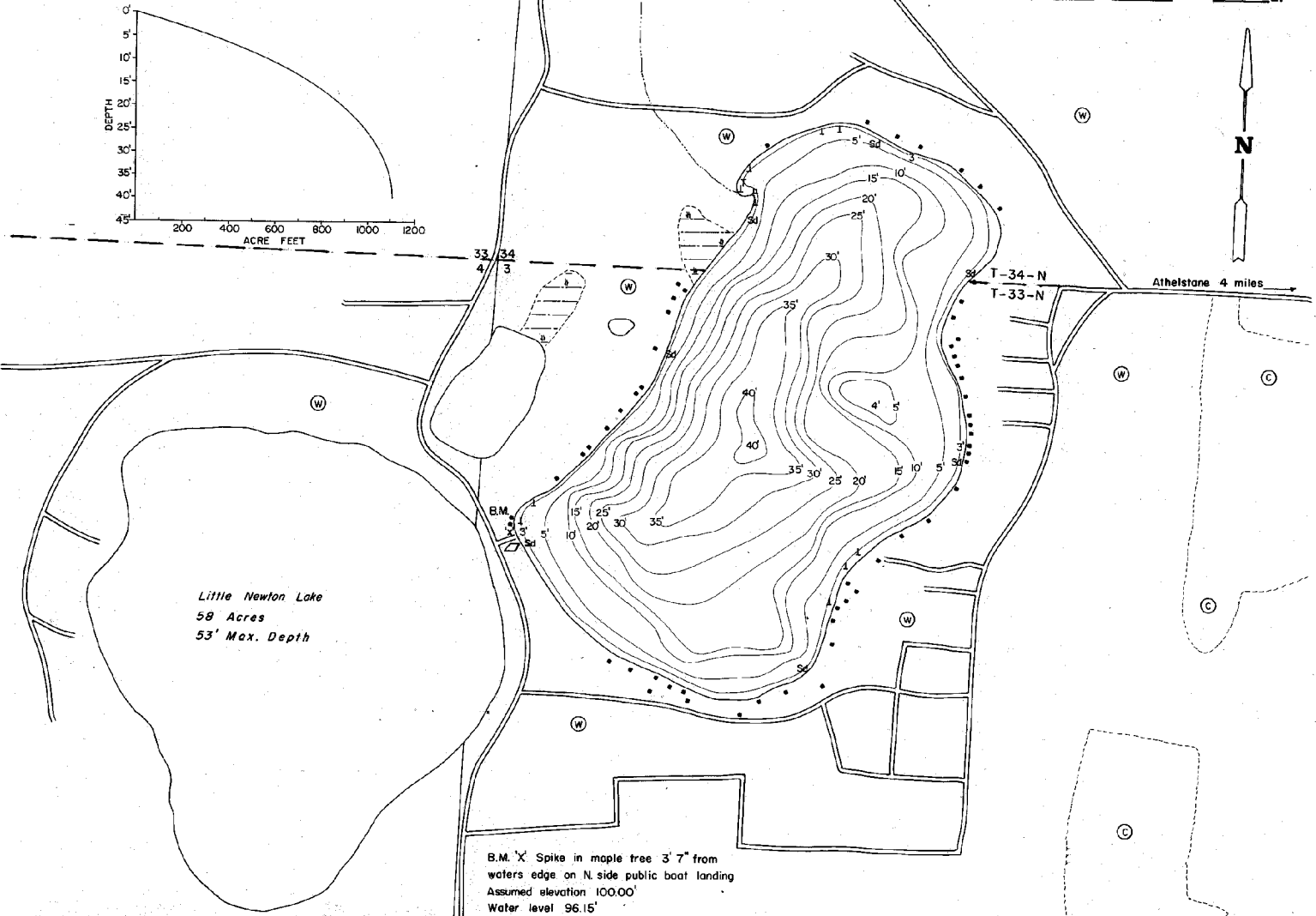

Little Newton Lake
58 Acres
53' Max. Depth

B.M. X Spike in maple tree 3' 7" from
waters edge on N. side public boat landing
Assumed elevation 100.00'
Water level 96.15'

- | | | | | | |
|--------------------------------|----------------------------|--------------------------|----------------------|----------------------------------|--------------------------|
| EQUIPMENT | RECORDING | SONAR | MAPPED | JULY | 1970 |
| TOPOGRAPHIC SYMBOLS | | | | MONTH LAKE BOTTOM SYMBOLS | |
| (B) Brush | (P) Partly wooded | (W) Wooded | (C) Cleared | (P) Pastured | (A) Agricultural |
| B.M. Bench Mark | Dwelling | Resort | Comp | (S) Steep slope | (I) Indefinite shoreline |
| (M) Marsh | (S) Spring | (IS) Intermittent stream | (PI) Permanent inlet | (PO) Permanent outlet | (D) Dam |
| (D.N.R.) State owned land | (P) Peat | (Mk) Muck | (C) Clay | (M) Marl | (Sd) Sand |
| (S) Silt | (Gr) Gravel | (R) Rubble | (Bc) Bedrock | (B) Boulders | (S&S) Stumps & Snags |
| (RD) Rock danger to navigation | (SV) Submergent vegetation | (FV) Floating vegetation | (BS) Brush shelters | | |

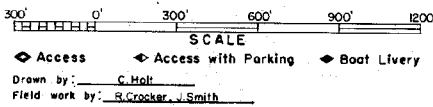

SPECIES OF FISH	ABUNDANT		PRESENT
	ABUNDANT	PRESENT	
Muskie			
N. Pike	X		
Walleye	X		
L.M. Bass	X		
S.M. Bass	X		
Panfish	X		
Trout			

WATER AREA 674 ACRES
UNDER 3 FT. 5.3 %
OVER 20 FT. 35 %
MAX. DEPTH 40 FEET.
TOTAL ALK. 126 P.P.M.
VOLUME 1105 ACRE FT.
SHORELINE 1.37 MILES

Maps are not for navigation
Source-Wisconsin Department of Natural Resources
Hunt Fish Camp Wisconsin .Com 2005