

STATE OF WISCONSIN
DEPARTMENT OF NATURAL RESOURCES

LAKE SURVEY MAP

BIG EAU PLEINE RESERVOIR MARATHON COUNTY
LAKE
SEC. AS SHOWN T.-26.27-N. R.-4.5.6-E.M.
(Sheet 8 of 8)

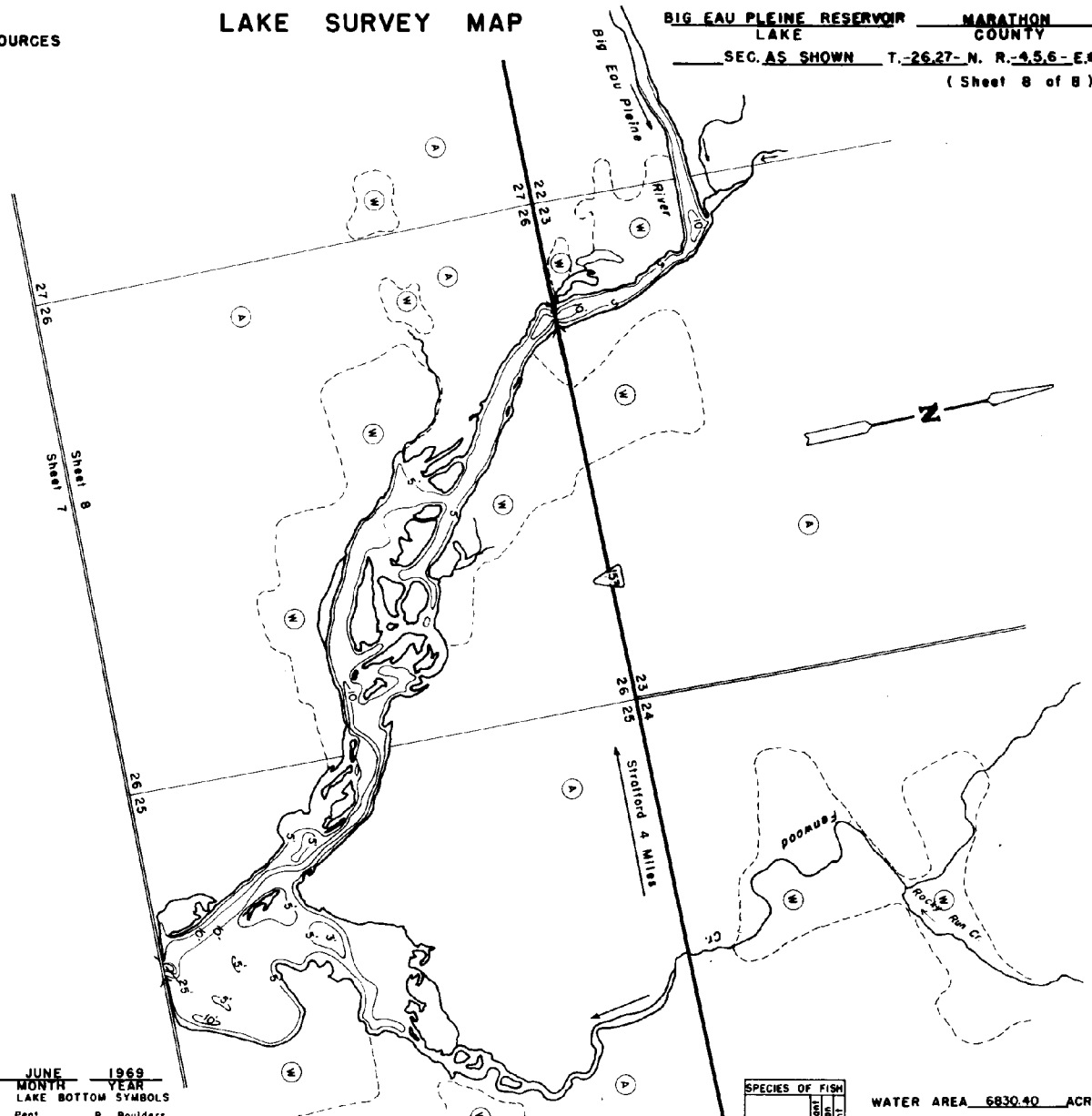
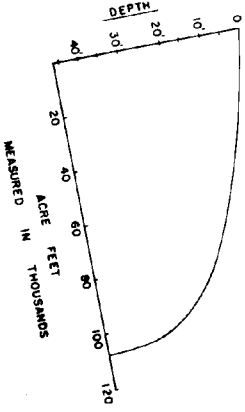

EQUIPMENT RECORDING SONAR MAPPED MONTH YEAR
JUNE 1969

- | TOPOGRAPHIC SYMBOLS | | LAKE BOTTOM SYMBOLS | |
|-----------------------|----------------------------|---------------------|-----------------------------|
| (B) Brush | Steep slope | P. Peat | B Boulders |
| (PW) Partially wooded | ----- Indefinite shoreline | Mk Muck | ⚡ Stumps & Snags |
| (W) Wooded | ⊞ Marsh | C. Clay | ⚠ Rock danger to navigation |
| (C) Cleared | ⊞ Spring | M. Marl | T Submergent vegetation |
| (P) Pastured | ⊞ Intermittent stream | Sd. Sand | ⊞ Emergent vegetation |
| (A) Agricultural | ⊞ Permanent inlet | St. Silt | ⊞ Floating vegetation |
| B.M. Bench Mark | ⊞ Permanent outlet | G. Gravel | ⊞ Brush shelters |
| ■ Dwelling | ⊞ Dam | R. Rubble | |
| ⊞ Resort | D.N.R. State owned land | Bc Bedrock | |
| ⊞ Camp | | | |



◆ Access ◆ Access with Parking ◆ Boat Livery
Drawn by: E. Eaton
Field work by: J. Smith

| SPECIES OF FISH | ABUNDANCE | |
|-----------------|-----------|---------|
| | Common | Present |
| Muskie | X | X |
| N. Pike | X | X |
| Walleye | X | X |
| L. M. Bass | X | X |
| S. M. Bass | X | X |
| Panfish | X | X |
| Trout | | |

WATER AREA 6830.40 ACRES
UNDER 3 FT. 7 %
OVER 20 FT. 31 %
MAX. DEPTH 46 FEET.
TOTAL ALK. 130 P.P.M.
VOLUME 106,602.22 ACRE FT.
SHORELINE 66.28 MILES

Maps are not for navigation
Source-Wisconsin Department of Natural Resources
Hunt Fish Camp Wisconsin .Com 2005