

STATE OF WISCONSIN  
DEPARTMENT OF NATURAL RESOURCES

LAKE SURVEY MAP

**BIG EAU PLEINE RESERVOIR** **MARATHON**  
LAKE COUNTY  
SEC. AS SHOWN T-26-27-N. R.-4-5-6-E.W.  
(Sheet 4 of 8)

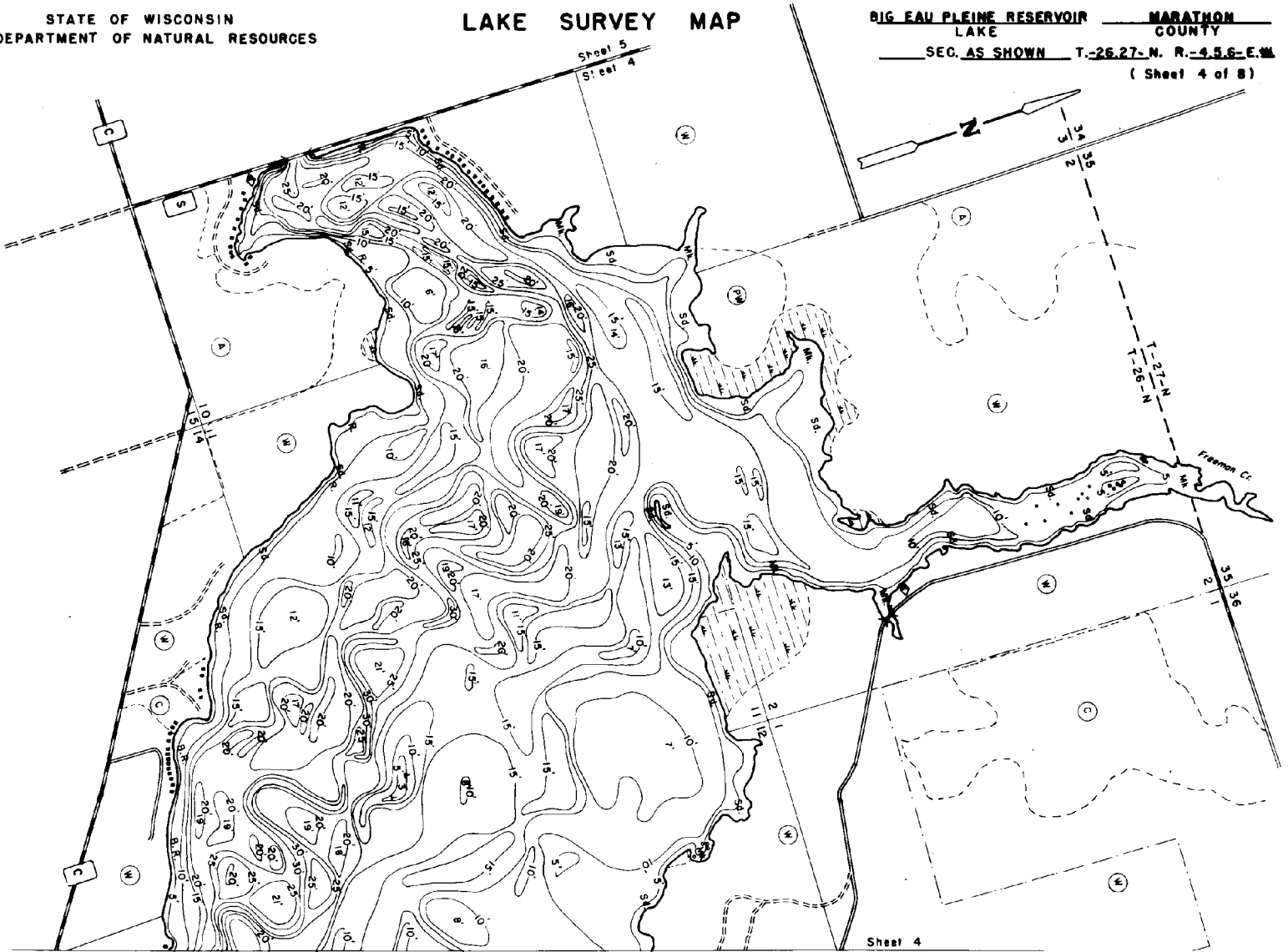

- EQUIPMENT RECORDING SONAR MAPPED JUNE 1969  
MONTH YEAR
- | TOPOGRAPHIC SYMBOLS   |                            | LAKE BOTTOM SYMBOLS |                              |
|-----------------------|----------------------------|---------------------|------------------------------|
| (S) Brush             | Steep slope                | P. Peat             | B Boulders                   |
| (PW) Partially wooded | ----- Indefinite shoreline | Mk Muck             | St Stumps & Snags            |
| (W) Wooded            | Marsh                      | C. Clay             | RD Rock danger to navigation |
| (C) Cleared           | Spring                     | M. Marl             | T Submergent vegetation      |
| (P) Pastured          | Intermittent stream        | Sd. Sand            | 1 Emergent vegetation        |
| (A) Agricultural      | Permanent inlet            | St. Silt            | F Floating vegetation        |
| B.M. Bench Mark       | Permanent outlet           | Gr. Gravel          | BS Brush shelters            |
| (D) Dwelling          | Dam                        | R. Rubble           |                              |
| (R) Resort            | D.N.R. State owned land    | Bc Bedrock          |                              |
| (C) Camp              |                            |                     |                              |

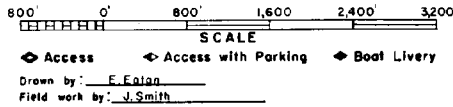

SPECIES OF FISH	ABUNDANCE	
	Common	Frequent
Muskie	X	X
N. Pike	X	X
Walleye	X	X
L. M. Bass	X	X
S. M. Bass	X	X
Panfish	X	X
Trotl		

WATER AREA 6830.40 ACRES  
UNDER 3 FT. 7 %  
OVER 20 FT. 31 %  
MAX. DEPTH 46 FEET.  
TOTAL ALK. 130 P.P.M.  
VOLUME 106,602.22 ACRE FT.  
SHORELINE 66.28 MILES

Maps are not for navigation  
Source-Wisconsin Department of Natural Resources  
Hunt Fish Camp Wisconsin .Com 2005