

STATE OF WISCONSIN
DEPARTMENT OF NATURAL RESOURCES

LAKE SURVEY MAP

BEVERLY LAKE SAWYER COUNTY
SEC. 16 T. 38 - N. R. 8 - E.W.

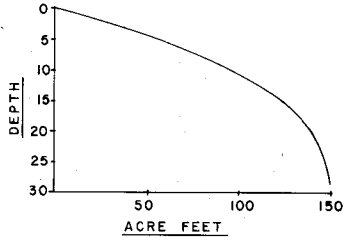
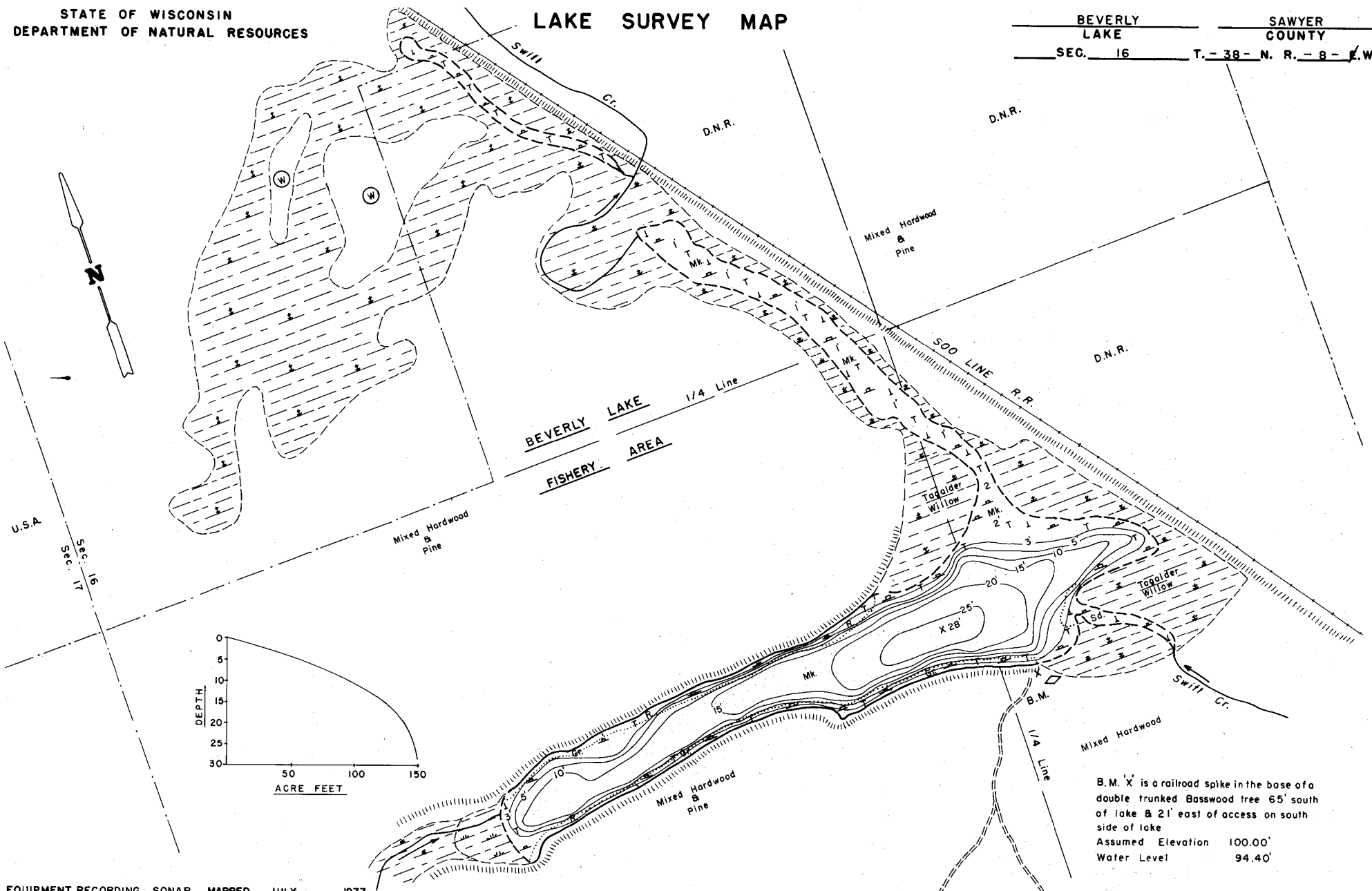

B.M. X is a railroad spike in the base of a double trunked Basswood tree 65' south of lake & 21' east of access on south side of lake
Assumed Elevation 100.00'
Water Level 94.40'

EQUIPMENT RECORDING SONAR MAPPED JULY 1977

TOPOGRAPHIC SYMBOLS		LAKE BOTTOM SYMBOLS	
(B) Brush	Steep slope	P. Peat	B. Boulders
(W) Partially wooded	- - - Indefinite shoreline	Mk. Muck	☼ Stumps & Snags
(W) Wooded	Marsh	C. Clay	☼ Rock danger to navigation
(C) Cleared	Spring	M. Marl	T Submergent vegetation
(P) Pastured	Intermittent stream	Sd. Sand	⊥ Emergent vegetation
(A) Agricultural	Permanent inlet	St. Silt	⊥ Floating vegetation
B.M. Bench Mark	Permanent outlet	Gr. Gravel	⊥ Brush shells
■ Dwelling	Dam	R. Rubble	
■ Resort	D.N.R. State owned land	Br. Bedrock	
■ Camp			



◆ Access ◆ Access with Parking ◆ Boat Livery

Drawn by: E. Eaton
Field work by: C. Busch, K. Cable, L. Sather

Couderay 6 Miles

SPECIES OF FISH	ABUNDANT	
	Common	Present
Muskie		
N. Pike		X
Walleye		X
L. M. Bass		X
S. M. Bass		X
Panfish		X
Trout		
Winnow	Y	

WATER AREA 16.2 ACRES
UNDER 3 FT. 37 %
OVER 20 FT. 15 %
MAX. DEPTH 28 FEET
TOTAL ALK. 32 P.P.M.
VOLUME 150.35 ACRE FT.
MAIN SHORELINE 1.6 MI.
ISLAND SHORELINE MI.