

STATE OF WISCONSIN
DEPARTMENT OF NATURAL RESOURCES

LAKE SURVEY MAP

BASS LAKE
PRICE COUNTY
SEC. 18 T. 38 N. R. 2 W.

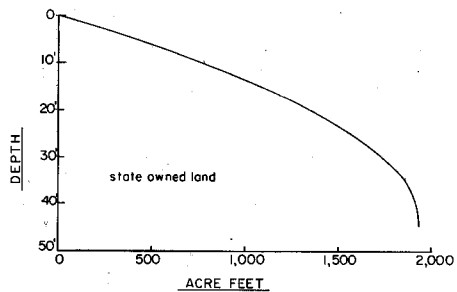

Department of Natural Resources Bench Mark.
Spike in the base of a 10" oak, 3' west of trail
and 5' north of water's edge.
Assumed Elevation 100.00'
Water Elevation 97.55'

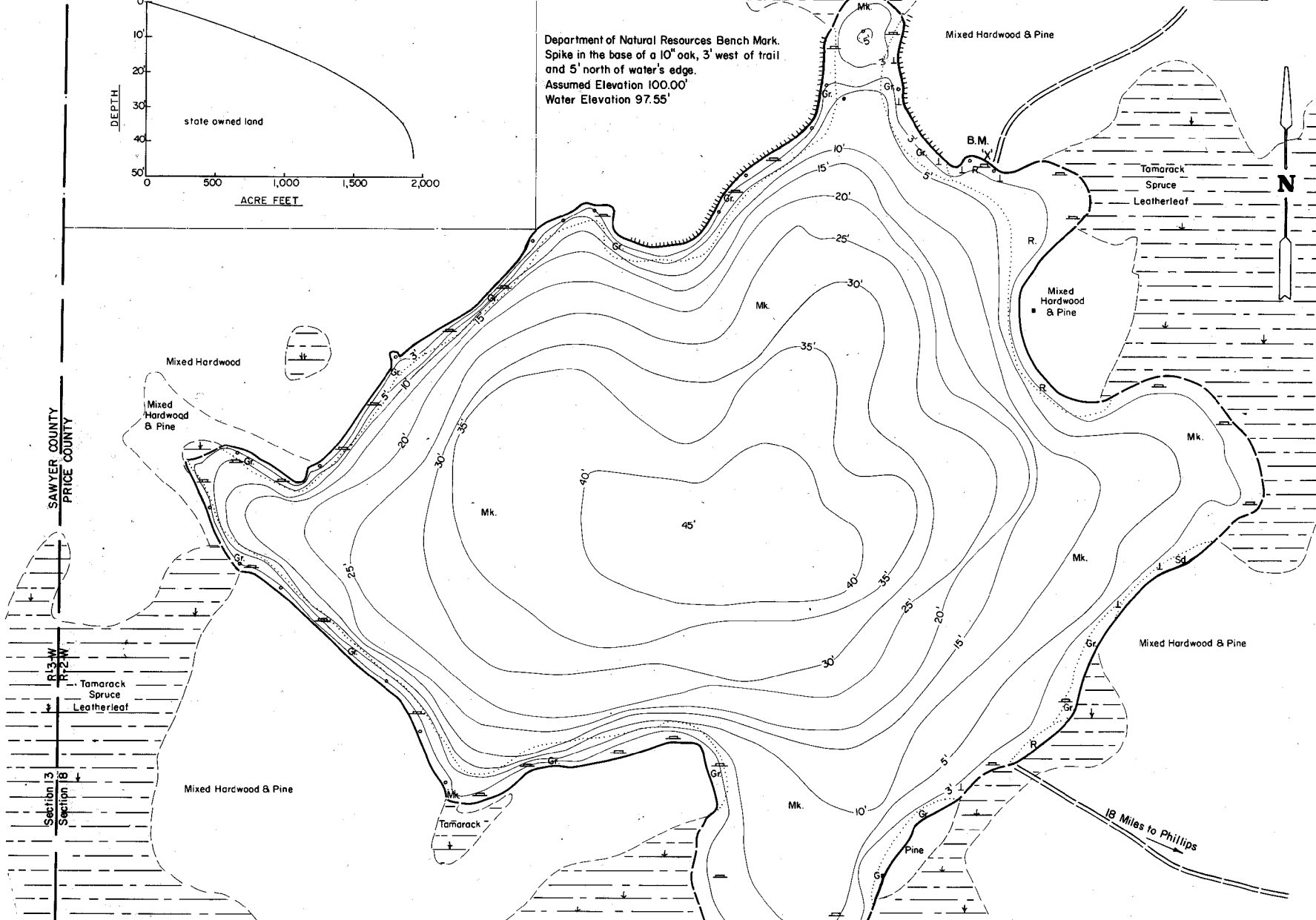

EQUIPMENT RECORDING SONAR MAPPED OCTOBER 1969

- | TOPOGRAPHIC SYMBOLS | | LAKE BOTTOM SYMBOLS | |
|-----------------------|----------------------------|---------------------|-----------------------------|
| (B) Brush | Steep slope | P. Peat | B Boulders |
| (PW) Partially wooded | ----- Indefinite shoreline | Mk. Muck | ⋄ Stumps & Snags |
| (W) Wooded | Marsh | C. Clay | ⚡ Rock danger to navigation |
| (C) Cleared | ⊙ Spring | M. Marl | T Submergent vegetation |
| (P) Pastured | ~ Intermittent stream | Sd. Sand | l Emergent vegetation |
| (A) Agricultural | == Permanent inlet | St. Silt | ⬆ Floating vegetation |
| B.M. Bench Mark | --- Permanent outlet | Gr. Gravel | ⬆ Brush shelters |

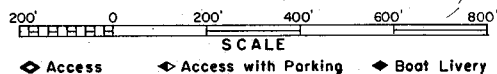

SPECIES OF FISH	Abundance		
	Abundant	Common	Present
Muskie			
N. Pike			
Wolleye			
L. M. Bass			X
S. M. Bass			X
Grass			

WATER AREA 94.0 ACRES
 UNDER 3 FT. 7 %
 OVER 20 FT. 52 %
 MAX. DEPTH 45 FEET.
 TOTAL ALK. 50 P.P.M.
 VOLUME 1,934.7 ACRE FT.
 CIRCUMFERENCE 1.07 MILES