

Hunt Fish Camp Wisconsin

STATE OF WISCONSIN
DEPARTMENT OF NATURAL RESOURCES

LAKE SURVEY MAP

BASS LAKE
SEC. 23, 24 T. 39 N. R. 16 W.
BURNETT COUNTY

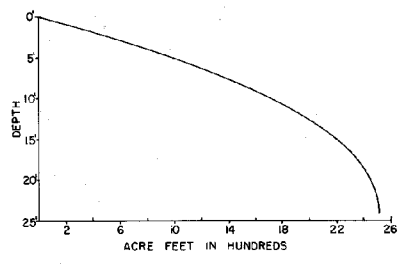
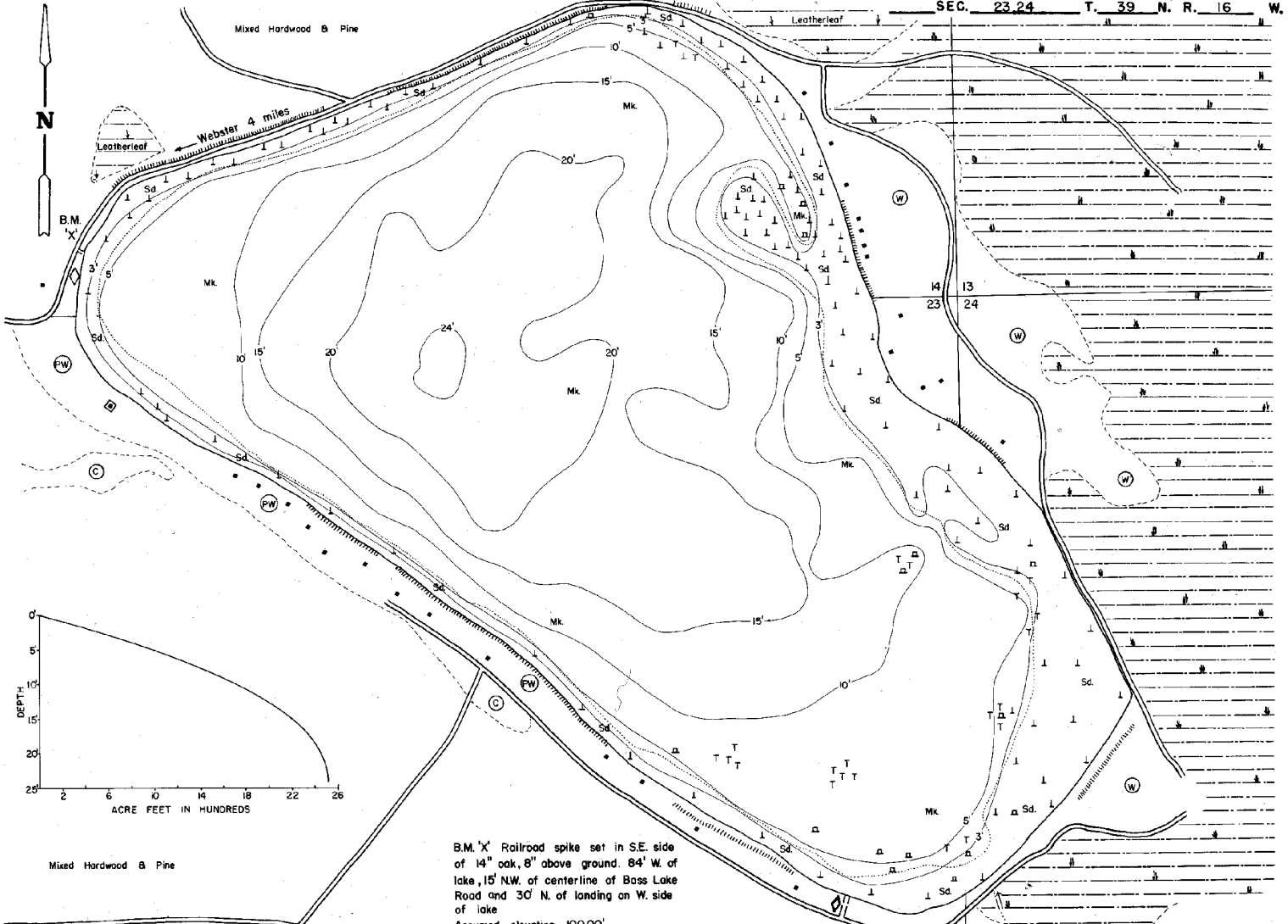

B.M. 'X' Railroad spike set in S.E. side of 14" oak, 8" above ground. 84' W. of lake, 15' N.W. of centerline of Bass Lake Road and 30' N. of landing on W. side of lake
Assumed elevation 100.00'
Water level 91.11'

- | | | |
|---|----------------------------|---------------------------|
| EQUIPMENT RECORDING SONAR MAPPED | AUG 1969 | MONTH YEAR |
| TOPOGRAPHIC SYMBOLS | LAKE BOTTOM SYMBOLS | |
| Brush | Peat | B Boulders |
| Partially wooded | Indefinite shoreline | Stumps & Snags |
| Wooded | Marsh | Rock danger to navigation |
| Cleared | Spring | Submergent vegetation |
| Pastured | Intermittent stream | Emergent vegetation |
| Agricultural | Permanent inlet | Floating vegetation |
| B.M. Bench Mark | Permanent outlet | Brush shelters |
| Dwelling | Dam | |
| Resort | D.N.R. State owned land | |
| Camp | | |

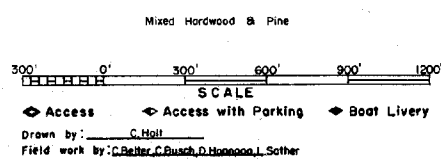

SPECIES OF FISH	WATER AREA	
	Abundant	Present
Muskie		
N. Pike	X	
Walleye	X	
L. N. Bass	X	
S. M. Bass	X	
Panfish	X	
Trout		

WATER AREA 226.13 ACRES
UNDER 3 FT. 15 %
OVER 20 FT. 13 %
MAX. DEPTH 24 FEET.
TOTAL ALK. 16 P.P.M.
VOLUME 2509.8 ACRE FT.
SHORELINE 2.40 MILES