

DEPARTMENT OF NATURAL RESOURCES

LAKE SURVEY MAP

DOUGLAS COUNTY  
LAKE  
SEC. 32.33 T. 45 N. R. 11 W.

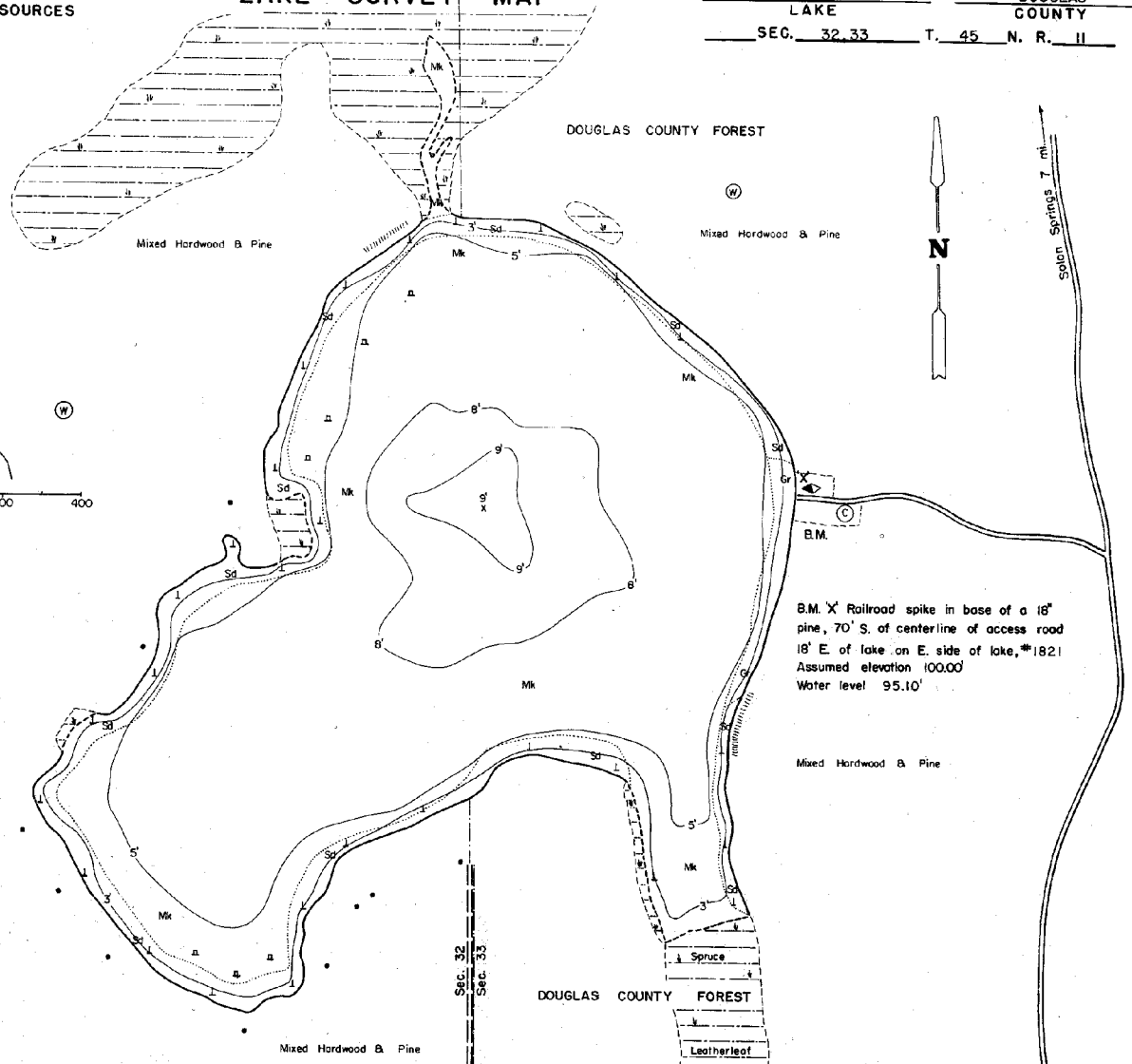
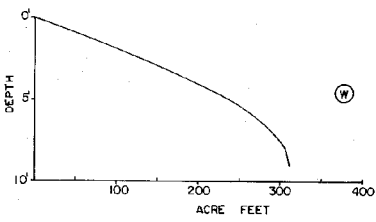

B.M. X Railroad spike in base of a 18' pine, 70' S. of centerline of access road 18' E. of lake on E. side of lake, #1821 Assumed elevation 100.00' Water level 95.10'

DOUGLAS COUNTY FOREST LAND

- EQUIPMENT RECORDING SONAR MAPPED MAY 1973
- TOPOGRAPHIC SYMBOLS
- (B) Brush
  - (PW) Partially wooded
  - (W) Wooded
  - (C) Cleared
  - (P) Pastured
  - (A) Agricultural
  - B.M. Bench Mark
  - (D) Dwelling
  - (R) Resort
  - (C) Camp

- LAKE BOTTOM SYMBOLS
- P. Peat
  - Mk. Muck
  - C. Clay
  - M. Marl
  - Sd. Sand
  - Sl. Silt
  - Gr. Gravel
  - R. Rubble
  - Bc. Bedrock
  - B. Boulders
  - Stumps & Snags
  - Rock danger to navigation
  - T. Submergent vegetation
  - Emergent vegetation
  - Floating vegetation
  - Brush shelters

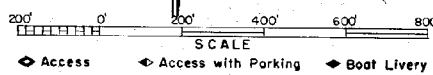

Access Access with Parking Boat Livery  
Drawn by: C. Holt  
Field work by: C. Busch, K. Cable, L. Sather

SPECIES OF FISH	Abundance	
	Common	Present
Muskie		
N. Pike	X	
Walleye	X	
L. M. Bass	X	
S. M. Bass		
Panfish	X	
Trout		

WATER AREA 527 ACRES  
UNDER 3 FT. 9 %  
OVER 20 FT. 0 %  
MAX. DEPTH 9 FEET.  
TOTAL ALK. 15 P.P.M.  
VOLUME 312 ACRE FT.  
SHORELINE 1.53 MILES

Maps are not for navigation  
Source-Wisconsin Department of Natural Resources  
Hunt Fish Camp Wisconsin .Com 2005