

Hunt Fish Camp Wisconsin

STATE OF WISCONSIN
DEPARTMENT OF NATURAL RESOURCES

LAKE SURVEY MAP

BASS LAKE
SEC. 8, 9 T. 38 N. R. 15 W.
BURNETT COUNTY

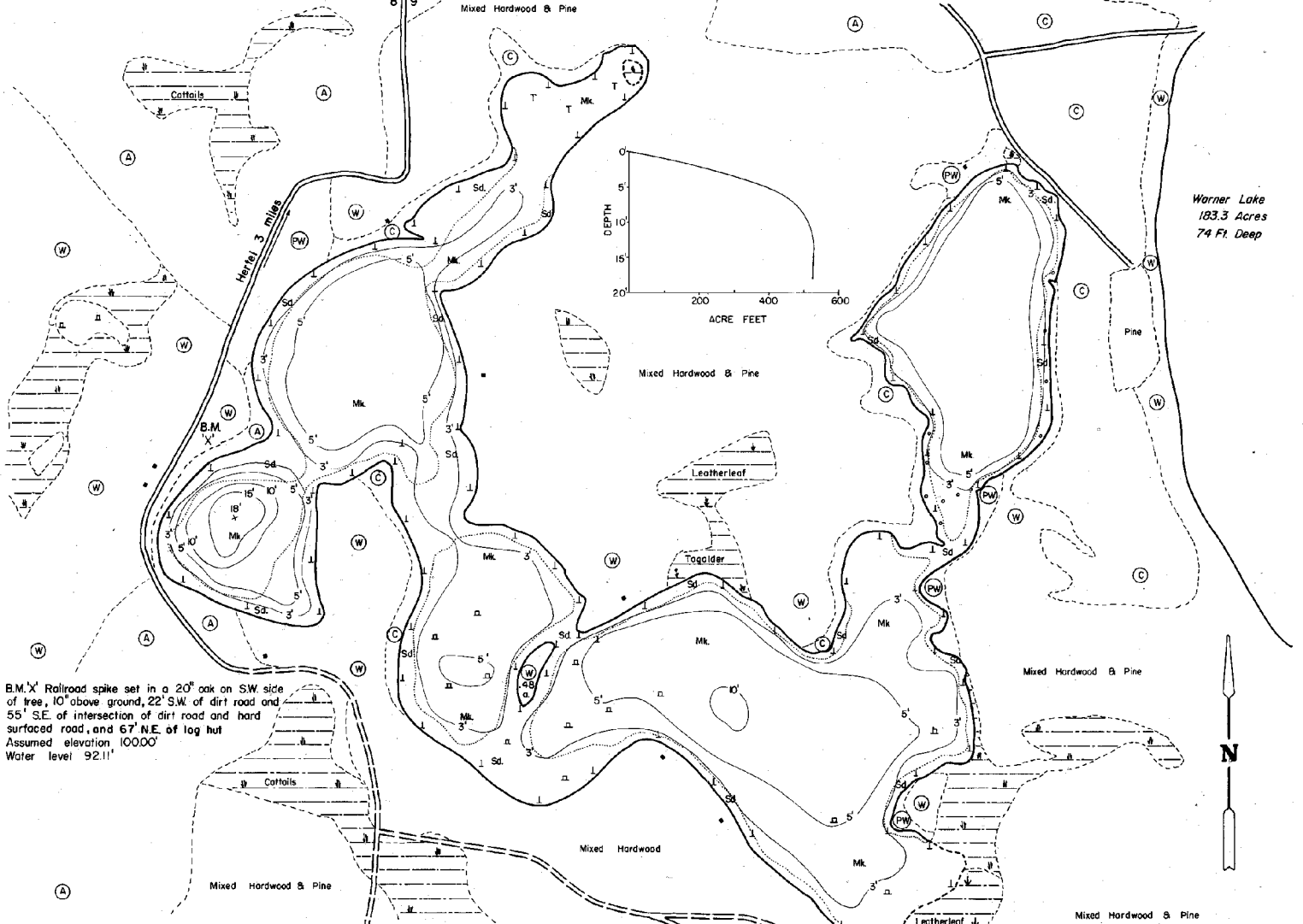

Warner Lake
183.3 Acres
74 Ft. Deep

B.M. X Railroad spike set in a 20" oak on SW side of tree, 10' above ground, 22' SW of dirt road and 55' S.E. of intersection of dirt road and hard surfaced road, and 67' N.E. of log hut
Assumed elevation 10000'
Water level 92.11'

- EQUIPMENT RECORDING SONAR MAPPED SEPT 1969
MONTH LAKE BOTTOM YEAR
- | TOPOGRAPHIC SYMBOLS | | LAKE BOTTOM SYMBOLS | |
|-----------------------|----------------------------|---------------------|-----------------------------|
| (B) Brush | Steep slope | P. Peat | B Boulders |
| (PW) Partially wooded | ----- Indefinite shoreline | Mk. Muck | ⚬ Stumps & Snags |
| (W) Wooded | ~ Marsh | C. Clay | ⚬ Rock danger to navigation |
| (C) Cleared | o Spring | M. Marl | T Submergent vegetation |
| (P) Pastured | ~ Intermittent stream | Sd. Sand | ⊥ Emergent vegetation |
| (A) Agricultural | ~ Permanent inlet | St. Silt | ⊥ Floating vegetation |
| B.M. Bench Mark | ~ Permanent outlet | G. Gravel | ⊥ Brush shelters |
| ■ Dwelling | ~ Dam | R. Rubble | |
| □ Resort | D.N.R. State owned land | Bz. Bedrock | |
| □ Camp | | | |

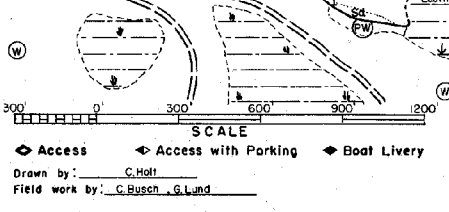

SPECIES OF FISH	ABUNDANCE	
	Common	Frequent
Muskie		
N. Pike	X	
Walleye		
L.M. Bass	X	
S.M. Bass		
Panfish	X	
Trout		

WATER AREA 110.0 ACRES
UNDER 3 FT. 34 %
OVER 20 FT. 0 %
MAX. DEPTH 18 FEET
TOTAL ALK. 7 P.P.M.
VOLUME 525.8 ACRE FT.
SHORELINE 396 MILES
SHORELINE 4.09 MILES WITH IS.

Source-Wisconsin Department of Natural Resources
Hunt Fish Camp Wisconsin .Com 2005