

WISCONSIN CONSERVATION DEPARTMENT

LAKE SURVEY MAP

LAKE ASHIPPUN
SECTION 15
TOWNSHIP 8-N
RANGE 17-E
TOWN OCONOMOWOC
COUNTY WALKESHA

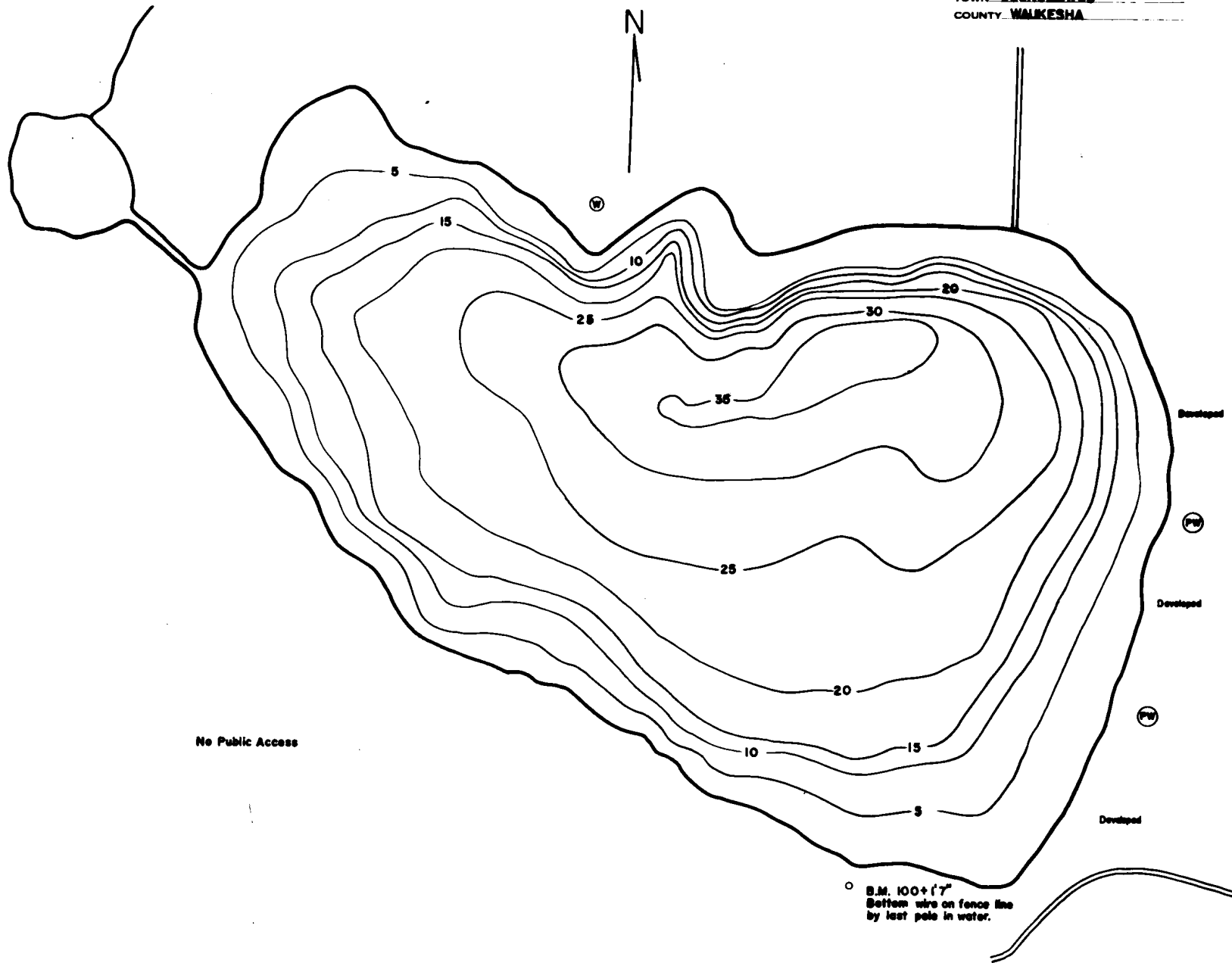

No Public Access

Developed

Developed

Developed

B.M. 100+17
Bottom wire on fence line
by last pole in water.

DATE 3/15/55
SOURCE OF INFORMATION W.C.D.

AREA 64.8 Acres
TOTAL SHORELINE 1.5 Miles
MAX. DEPTH 35 Feet