

STATE OF WISCONSIN  
DEPARTMENT OF NATURAL RESOURCES

LAKE SURVEY MAP

ANTLER LAKE POLK COUNTY  
SEC. 12 T. 35 N. R. 17 W.

B.M. 'X' Railroad spike set in S. side of double 10" elm tree, 25' S. of centerline of town road, 12' E. of mobile home and 45' N. of lake  
Assumed elevation 100.00'  
Water level 95.58'

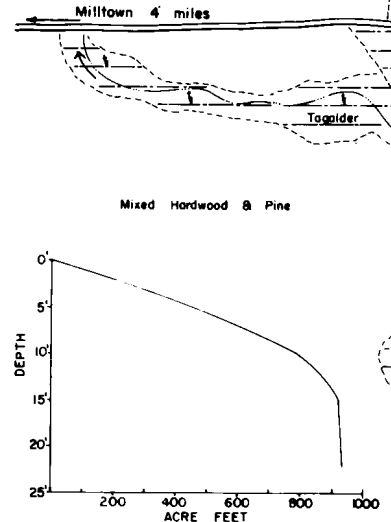
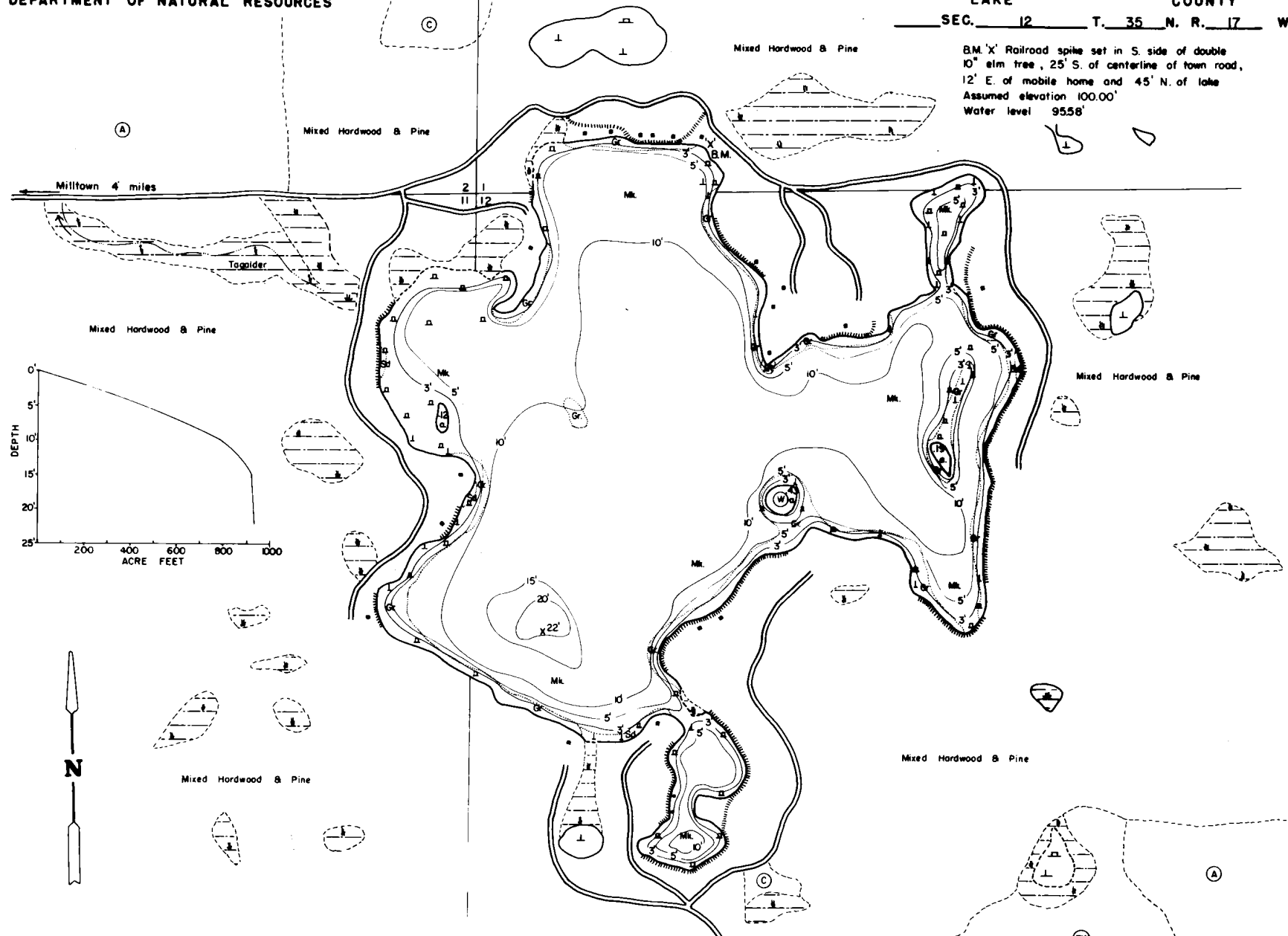

- EQUIPMENT RECORDING SONAR MAPPED AUG 1969
- | TOPOGRAPHIC SYMBOLS  |                        | LAKE BOTTOM SYMBOLS |                             |
|----------------------|------------------------|---------------------|-----------------------------|
| (B) Brush            | Steep slope            | P. Peat             | B Boulders                  |
| (W) Partially wooded | ~ Indefinite shoreline | Mk. Muck            | ⚡ Slumps & Snags            |
| (C) Wooded           | ~ Marsh                | C. Clay             | ⚡ Rock danger to navigation |
| (P) Cleared          | ~ Spring               | M. Marl             | T Submergent vegetation     |
| (A) Pastured         | ~ Intermittent stream  | Sd. Sand            | ⊥ Emergent vegetation       |
| (A) Agricultural     | ~ Permanent inlet      | Sl. Silt            | ⊥ Floating vegetation       |
| B.M. Bench Mark      | ~ Permanent outlet     | Gr. Gravel          | ⚡ Brush shelters            |

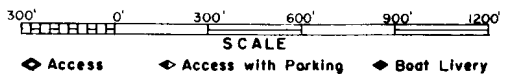

SPECIES OF FISH	Abundance		
	Common	Present	
Muskie			
N. Pike	X		
Wolleye			
L. M. Bass	X		
S. M. Bass			
Snowflake			

WATER AREA 101.4 ACRES  
 UNDER 3 FT. 12 %  
 OVER 20 FT. 1.0 %  
 MAX. DEPTH 22 FEET  
 TOTAL ALK. 14 P.P.M.  
 VOLUME 932.4 ACRE FT.