

STATE OF WISCONSIN  
DEPARTMENT OF NATURAL RESOURCES

LAKE SURVEY MAP

MASON  
LAKE

ADAMS, MARQUETTE  
COUNTY

SEC. 25, 26, 30, 31, 35, 36 T. 13, 14 N. R. 7, 8 E.

McCall Lake  
4.4 Acres  
0.34 Mi. Shoreline  
37 Ft. Deep

Amey Pond  
59.2 Acres  
1.61 Mi. Shoreline

B.M. X Top of cement wall  
upstream side of dam  
Assumed elevation 100.00'  
Water level 98.80'

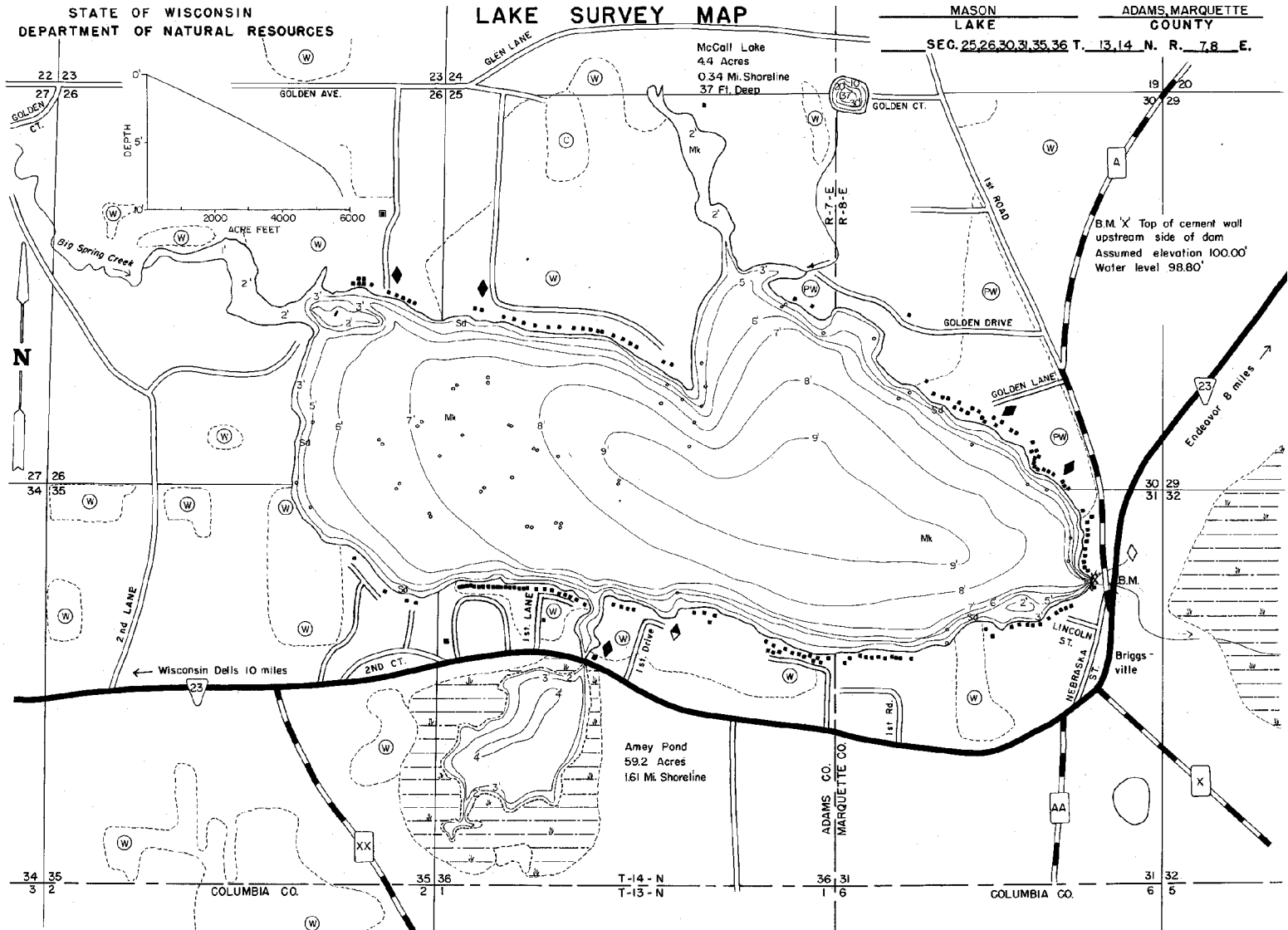

EQUIPMENT RECORDING SONAR MAPPED JUNE 1970

- TOPOGRAPHIC SYMBOLS**
- (B) Brush
  - (W) Partly wooded
  - (W) Wooded
  - (C) Cleared
  - (P) Pastured
  - (A) Agricultural
  - B.M. Bench Mark
  - (D) Dwelling
  - (R) Resort
  - (C) Camp
- LAKE BOTTOM SYMBOLS**
- (S) Steep slope
  - (I) Indefinite shoreline
  - (M) Marsh
  - (S) Spring
  - (I) Intermittent stream
  - (P) Permanent inlet
  - (O) Permanent outlet
  - (D) Dam
  - (S) D.N.R. State owned land
- LAKE BOTTOM SYMBOLS**
- (P) Peat
  - (Mk) Muck
  - (C) Clay
  - (M) Marl
  - (Sd) Sand
  - (Sl) Silt
  - (Gr) Gravel
  - (R) Rubble
  - (Bt) Bedrock
  - (B) Boulders
  - (S&S) Stumps & Snags
  - (R) Rock danger to navigation
  - (S) Submergent vegetation
  - (E) Emergent vegetation
  - (F) Floating vegetation
  - (BS) Brush shelters



Access symbols: Access, Access with Parking, Boat Livery

Drawn by: C. Hall  
Field work by: M. Schrage, G. Werdin

SPECIES OF FISH	ABUNDANCE	
	Abundant	Common
Muskie		X
N. Pike		X
Walleye		X
L.M. Bass	X	
S.M. Bass		
Panfish	X	
Trout		

WATER AREA 855.6 ACRES  
UNDER 3 FT. 8 %  
OVER 20 FT. 0 %  
MAX. DEPTH 9 FEET  
TOTAL ALK. 146.0 P.P.M.  
VOLUME 5783.7 ACRE FT.  
SHORELINE 7.53 MILES

Maps are not for navigation  
Source-Wisconsin Department of Natural Resources  
Hunt Fish Camp Wisconsin .Com 2005