

STATE OF WISCONSIN  
DEPARTMENT OF NATURAL RESOURCES

LAKE SURVEY MAP

ADA LAKE  
LANGLADE COUNTY  
SEC. 3, 4 T. 33 N. R. 14 E. SW

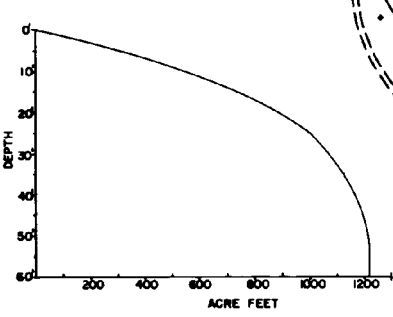
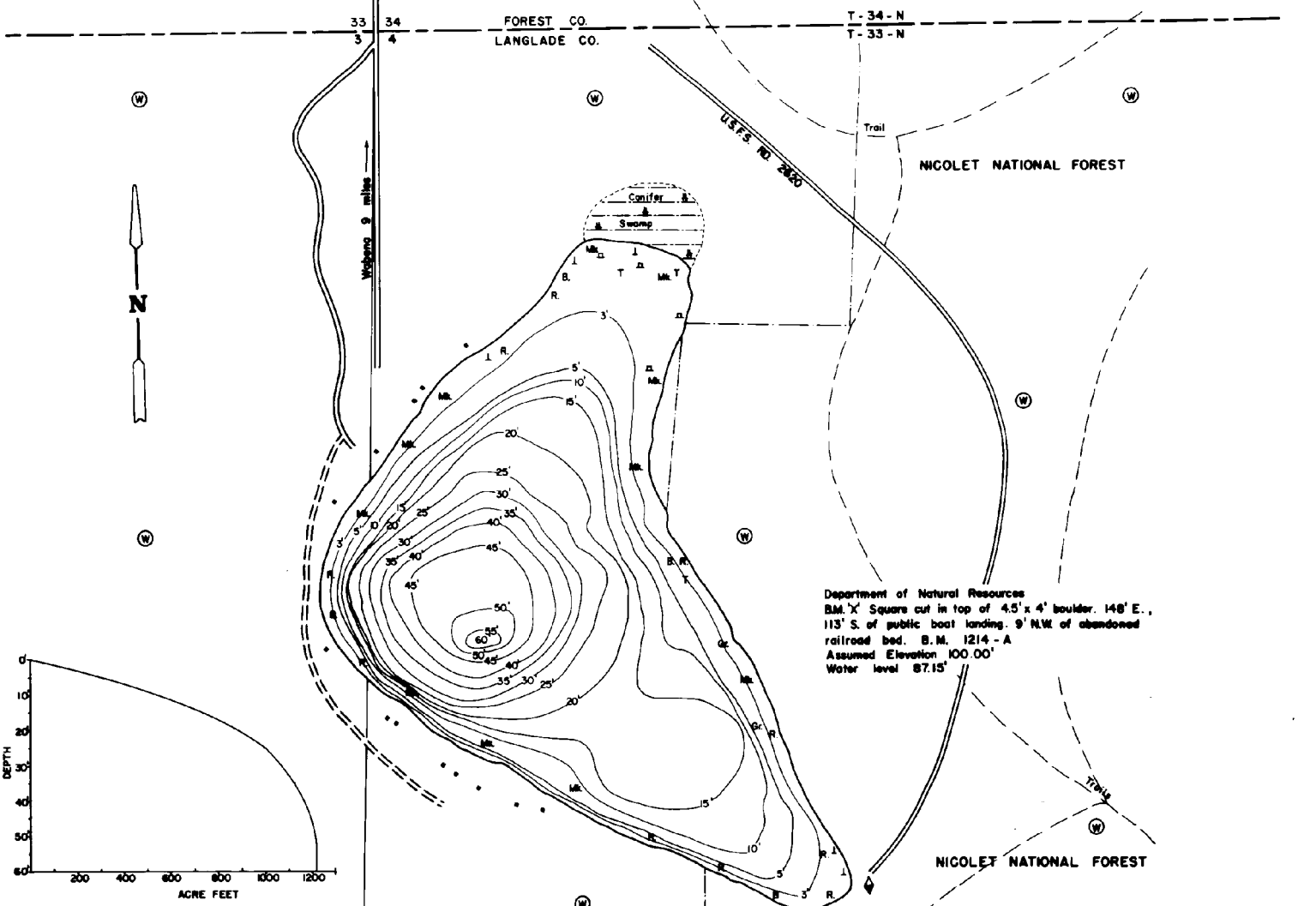

Department of Natural Resources  
B.M. 'X' Square cut in top of 4.5' x 4' boulder. 148' E.,  
113' S. of public boat landing. 9' N.W. of abandoned  
railroad bed. B.M. 1214-A  
Assumed Elevation 100.00'  
Water level 87.15'

- EQUIPMENT RECORDING SONAR MAPPED AUG 1967
- | TOPOGRAPHIC SYMBOLS |                               | LAKE BOTTOM SYMBOLS |                             |
|---------------------|-------------------------------|---------------------|-----------------------------|
| ① Brush             | (---) Steep slope             | P. Peat             | B Boulders                  |
| ② Partially wooded  | (---) Indefinite shoreline    | M. Muck             | ⚡ Stumps & Snags            |
| ③ Wooded            | (---) Marsh                   | C. Clay             | ⚡ Rock danger to navigation |
| ④ Cleared           | (---) Spring                  | M. Marl             | T Submerged vegetation      |
| ⑤ Pastured          | (---) Intermittent stream     | Sd. Sand            | ⚡ Emergent vegetation       |
| ⑥ Agricultural      | (---) Permanent inlet         | Sl. Silt            | ⚡ Floating vegetation       |
| B.M. Bench Mark     | (---) Permanent outlet        | Gr. Gravel          | ⚡ Brush shelters            |
| Ⓜ Dwelling          | (---) Dam                     | R. Rubble           |                             |
| Ⓜ Resort            | (---) D.M.R. State owned land | Bc Bedrock          |                             |
| Ⓜ Camp              |                               |                     |                             |

300' 0' 300' 600' 900' 1200'

SCALE

◊ Access ◊ Access with Parking ◊ Boat Livery

Drawn by: G. Holt  
Field work by: P. Michelson, J. Smith

SPECIES OF FISH	1967	
	Abundant	Present
Muskie		X
N. Pike		X
Shiners		X
L. N. Bass	X	
S. N. Bass	X	
Walleye	X	
Trout		X
Salmon		X

WATER AREA 72.9 ACRES  
UNDER 3 FT. 17.8 %  
OVER 20 FT. 32 %  
MAX. DEPTH 60 FEET.  
TOTAL ALK. 5 P.P.M.  
VOLUME 1213.6 ACRE FT.  
SHORELINE 1.8 MILES

Maps are not for navigation  
Source-Wisconsin Department of Natural Resources  
Hunt Fish Camp Wisconsin .Com 2005